

CONEC SUPERCON

HYBRID CONNECTORS

CONEC[®]
TECHNOLOGY IN CONNECTORS[™]





TECHNOLOGY IN CONNECTORS™

Industry 4.0, the current trend of increasing automation and data exchange in manufacturing environments, has resulted in new demands on electronic connectors.

More data, being transferred at faster speeds, and the need for high reliability in sometimes harsh environments, has forced the development of new connectors.

CONEC's nearly 40 years of experience positions us to be a world leader in these interconnect products.

CONEC is a global player with its own subsidiaries and/or production facilities in Canada, United States, China, Czech Republic, Poland, France and UK.

At our headquarters in Lippstadt, CONEC has a large Research and Development Department, its own tooling shop, a CNC precision turnery and a plastic injection moulding plant.

CONEC Germany, Lippstadt



CONEC Canada, Brampton



CONEC USA, Garner





In addition to a variety of connectors for all current standards, our particular strength is the development of customized solutions.

CONEC products are used in automation, telecommunications and energy technology, mechanical engineering, agriculture and medical technology, transportation and aviation industry.

Our synchronous production system „CONEC active“ is based on the principles of lean production and is the key to our sustained success.

In particular, we consider one of our strengths to be in the field of integrated moulding of components and assemblies.

To us, absolute customer orientation means: To deliver the right product at the right time, in the right quantity and the right quality to the right place.



CONEC SUPERCON HYBRID CONNECTORS

| | |
|---|----|
| One single connector system for many different applications | 5 |
| Nomenklature CONEC SuperCon Hybrid connectors overmoulded | 8 |
| Product specification CONEC SuperCon Hybrid connectors overmoulded | 9 |
| Nomenklature CONEC SuperCon Hybrid connectors field attachable | 10 |
| Product specification CONEC SuperCon Hybrid connectors field attachable | 11 |
| Nomenklature CONEC SuperCon Hybrid receptacles | 12 |
| Product specification CONEC SuperCon Hybrid receptacles | 13 |
| B12 Hybrid connectors overmoulded | 14 |
| B12 Hybrid connectors field attachable | 15 |
| B12 Hybrid receptacles | 16 |
| B17 Hybrid connectors overmoulded | 28 |
| B17 Hybrid connectors field attachable | 29 |
| B17 Hybrid receptacles | 31 |
| B23 Hybrid connectors (Preview) | 43 |

ACCESSORIES

| | |
|--------------------------|----|
| Tools, Hybrid cables | 46 |
| Color coding | 47 |
| Protection caps, Hex nut | 48 |

Part number index numeric

ADDITIONAL CONEC PRODUKT CATEGORIES

| | |
|--|----|
| Connectors overmoulded, Connectors field attachable | 52 |
| Sockets, Sockets SMT/THR | 53 |
| Panel plugs, Power connectors | 54 |
| HT, F&B connectors, BUS systems | 55 |
| Junction systems, IP67 Power Bayonet | 56 |
| IP67 Mini USB, USB, IP67 RJ45 Industrial Ethernet connectors | 57 |
| IP67 Fiber Optic LC Duplex, D-SUB connectors | 58 |
| D-SUB Filter connectors, D-SUB hoods | 59 |
| IP67 D-SUB connectors, IP67 Filter D-SUB connectors | 60 |
| IP67 hoods, PCB connectors | 61 |

CONEC SUPERCON HYBRID CONNECTORS

One single connector system for many different applications

Are you familiar with the problem of space caused by complex wiring?



We have the solution: CONEC SuperCon Hybrid connectors

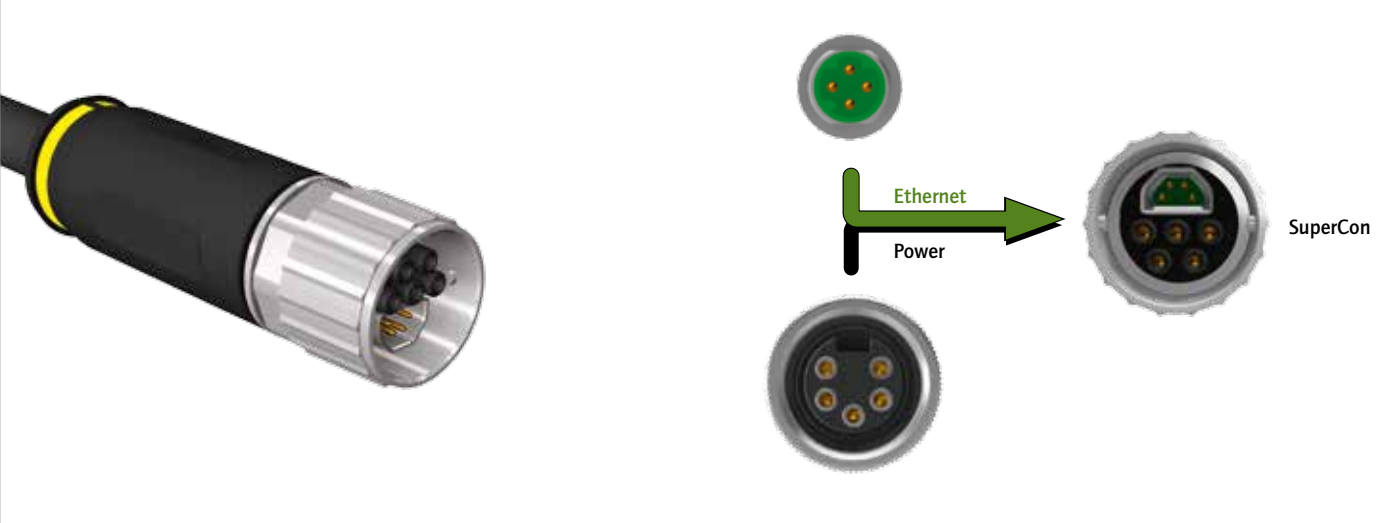

Example

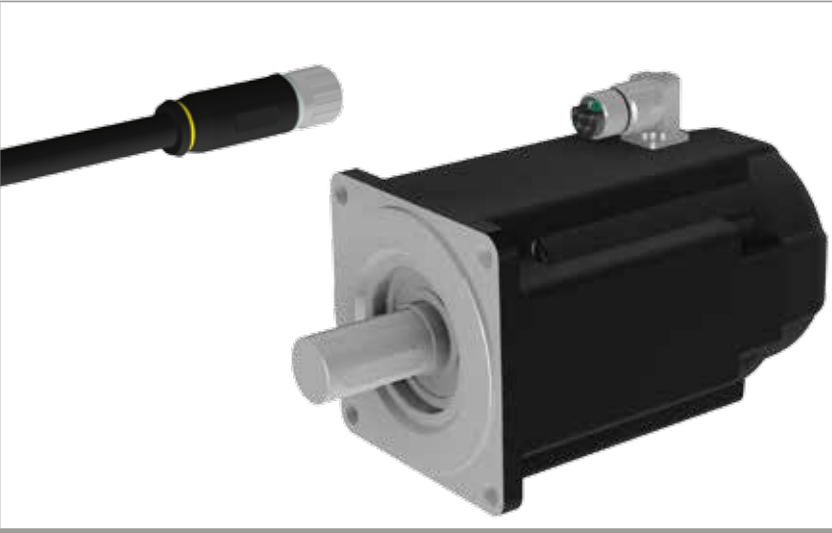

The CONEC SuperCon Hybrid connector series combines power supply and data transmission in one connector. Different sizes for various power classes from drives or devices offer maximum flexibility. Whether for small DC drives or powerful servo drives, CONEC SuperCon Hybrid connectors are the perfect solution.

CONEC SUPERCON HYBRID CONNECTORS

One single connector system for many different applications

Installation size and contact variants

Installation size B12



Installation size B17



Installation size B23



- Complete product range with different sizes: B12, B17 and B23
- Consistent data element for all sizes B12, B17 and B23
- Complete 360° shielding
- Different no. of power contacts for each size
 - 2 (size B12, 60 V)
 - 2 + PE (size B17, 250 V)
 - 2 + PE (size B17, 600 V)
 - 3 + PE (size B17, 600 V)
 - 4 + PE (size B17, B23, 600 V)
 - 2 + 3 + PE (size B23, 600 V)

SuperCon Cable for size B12 and B17

Installation size B12



Installation size B17



Installation size B23



Cable design

- 2 x 0.75 mm² + (4 x 1 x AWG22)
- 3 G 1.5 mm² + (4 x 1 x AWG22)
- 3 G 2.5 mm² + (4 x 1 x AWG22)
- 5 G 1.5 mm² + (4 x 1 x AWG22)
- 5 G 4 mm² + (4 x 1 x AWG22)
- 2 G 2.5 mm² + 4 G 4 mm² + (4 x 1 x AWG22)
- Suitable for drag-chains
- Variants with outer shielding available on request

Mechanical coding with visual color-marking

Coding 1



Coding 2



Coding 3



- Different angle positions of the contact carrier towards the bayonet locking allow several codings which are not pluggable with each other
- Each size is available with at least two codings
- The coding is indicated by colored rings

CONEC SUPERCON HYBRID CONNECTORS

One single connector system for many different applications

Overmoulded connectors B12, B17 and B23

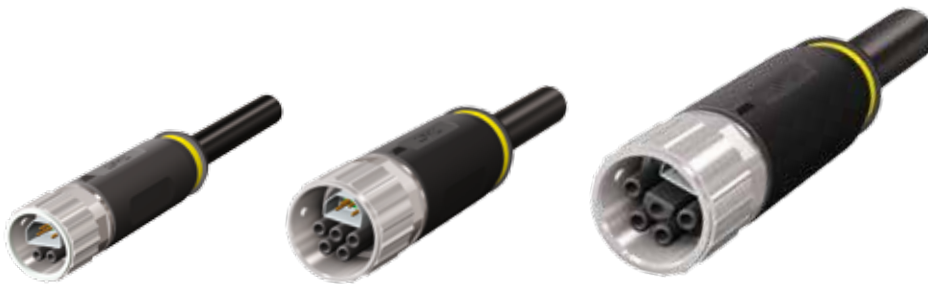

- Pre-assembled moulded open end and connection cables in different standard lengths
- Electrically tested, also tested as to transmission properties according to IEC 11801
- Tamper-proof
- Quick and secure connection by bayonet locking

Field attachable connectors B12, B17 and B23 easy installation because of poka-yoke



- Easy installation right inside the machine possible
- Cables specifically designed for these connectors allow easy installation of field attachable connectors.
- Quick and secure connection by bayonet locking

Receptacles



Receptacles available in six different versions:

- Front panel mounting, short or long version
- Back panel mounting, short or long version
- Square receptacles, short or long version
- Quick and secure connection by bayonet locking

CONEC SUPERCON HYBRID CONNECTORS OVERMOULDED

Nomenclature

| | ENP | - | 17 | - | 1 | - | R | K | Pst | 4PE | Dbu | 4 | - | 2 | / | GAZ | / | 150 | / | 034 | / | A1002 | |
|--|-----|---|----|---|---|---|---|---|-----|-----|-----|---|---|---|---|-----|---|-----|---|-----|---|-------|--|
| Ethernet-Power 100 MHz Cat5e | | | | | | | | | | | | | | | | | | | | | | | |
| Installation size 12 = B12 17 = B17 23 = B23 | | | | | | | | | | | | | | | | | | | | | | | |
| Shielding = unshielded | | | | | | | | | | | | | | | | | | | | | | | |
| Coding 1 = Coding 1 2 = Coding 2 3 = Coding 3 | | | | | | | | | | | | | | | | | | | | | | | |
| Type R = Circular connectors | | | | | | | | | | | | | | | | | | | | | | | |
| Gender K = Female connector S = Male connector | | | | | | | | | | | | | | | | | | | | | | | |
| Configuration = axial | | | | | | | | | | | | | | | | | | | | | | | |
| Type of power contacts Pst = Power contacts male Pbu = Power contacts female | | | | | | | | | | | | | | | | | | | | | | | |
| No. of power contacts 2 = 2-pos. (60 V) 2PE = 2-pos.+PE (600 V) 2PEA = 2-pos.+PE (250 V) 3PE = 3-pos.+PE (600 V) 4PE = 4-pos.+PE (600 V) 5PE = 2-pos.+3-pos.+PE (600 V) | | | | | | | | | | | | | | | | | | | | | | | |
| Type of data contacts Dst = Data contacts male Dbu = Data contacts female | | | | | | | | | | | | | | | | | | | | | | | |
| No. of data contacts 4 = 4-pos. | | | | | | | | | | | | | | | | | | | | | | | |
| Cable length XX = Length [m] | | | | | | | | | | | | | | | | | | | | | | | |
| Cable quality GAZ = PUR black | | | | | | | | | | | | | | | | | | | | | | | |
| Wire cross section power contact 075 = 0.75 mm ² 150 = 1.50 mm ² 250 = 2.50 mm ² 400 = 4.00 mm ² 250 + 400 = 2.50 mm ² + 4.00 mm ² | | | | | | | | | | | | | | | | | | | | | | | |
| Wire cross section data contact 034 = 0.34 mm ² | | | | | | | | | | | | | | | | | | | | | | | |
| Color of overmould A1002 = black | | | | | | | | | | | | | | | | | | | | | | | |

CONEC SUPERCON HYBRID CONNECTORS OVERMOULDED

Product specification

| Basic material | |
|------------------------|---|
| Contact | Copper alloy |
| Contact plating | Nickel plated, gold plated |
| Contact carrier | PA6, UL94 |
| Overmould | TPU UL94, black |
| Sealing | NBR, FPM |
| Coupling nut/screw | GD-Zn, Ni |
| Shield sleeve | CuZn, Ni |
| Technical data | |
| Rated voltage power | Size B12: 60 V DC Size B17: 250 V (2PEA), 600 V (2PE, 3PE, 4PE) |
| Rated voltage data | 24 V DC |
| Current rating power | Size B12: 10 A @ 30 °C Size B17: 20 A (2PEA), 14 A (2PE, 3PE, 4PE) @ 30 °C |
| Current rating data | 3 A @ 30 °C |
| Degree of protection | IP67 |
| Temperature range | -20 °C - +80 °C |
| Terminal cross section | Size B12: 0.75 mm ² + AWG22 Size B17: 2.5 mm ² + AWG22 (2PEA), 1.5 mm ² + AWG22 (2PE, 3PE, 4PE) |

CONEC SUPERCON HYBRID CONNECTORS FIELD ATTACHABLE

Nomenclature

ENP - 17 - 0 - R K C Pst 4PE Dbu 4 / 150 / 034

Ethernet-Power
100 MHz Cat5e

Installation size

12 = B12
17 = B17
23 = B23

Shielding

= unshielded

Coding

0 = Coding selectable during assembly

Type

R = Circular connectors

Gender

K = Female connector
S = Male connector

Configuration

= axial

Configuration

C = field attachable

Type of power contacts

Pst = Power contacts male
Pbu = Power contacts female

No. of power contacts

2 = 2-pos. (60 V)
2PE = 2-pos.+PE (600 V)
2PEA = 2-pos.+PE (250 V)
3PE = 3-pos.+PE (600 V)
4PE = 4-pos.+PE (600 V)
5PE = 2-pos.+3-pos.+PE (600 V)

Type of data contacts

Dst = Data contacts male
Dbu = Data contacts female

No. of data contacts

4 = 4-pos.

Wire cross section power contact

075 = 0.75 mm²
150 = 1.50 mm²
250 = 2.50 mm²
400 = 4.00 mm²
250 + 400 = 2.50 mm² + 4.00 mm²

Wire cross section data contacts

034 = 0.34 mm²

CONEC SUPERCON HYBRID CONNECTORS FIELD ATTACHABLE

Product specification

| Basic material | |
|------------------------|---|
| Contact | Copper alloy |
| Contact plating | Nickel plated, gold plated |
| Contact carrier | PA6, UL94 |
| Housing | CuZn, Ni |
| Cable sealing | NBR |
| Sealing | NBR, FPM |
| Coupling nut/screw | GD-Zn, Ni |
| Technical data | |
| Rated voltage power | Size B12: 60 V DC Size B17: 250 V (2PEA), 600 V (2PE, 3PE, 4PE) |
| Rated voltage data | 24 V DC |
| Current rating power | Size B12: 10 A @ 30 °C Size B17: 20 A (2PEA), 14 A (2PE, 3PE, 4PE) @ 30 °C |
| Current rating data | 3 A @ 30 °C |
| Degree of protection | IP67 |
| Temperature range | -20 °C - +80 °C |
| Terminal cross section | Size B12: 0.75 mm ² + AWG22 Size B17: 2.5 mm ² + AWG22 (2PEA), 1.5 mm ² + AWG22 (2PE, 3PE, 4PE) |

CONEC SUPERCON HYBRID RECEPTACLES

Nomenclature

| | ENP | - | 17 | - | 1 | - | F | K | H | Pst | 4PE | Dst | 4 | - | 1 | / | 1 | / | G6 | / | 150 | / | 034 |
|--|-----|---|----|---|---|---|---|---|---|-----|-----|-----|---|---|---|---|---|---|----|---|-----|---|-----|
| Ethernet-Power 100 MHz Cat5e | | | | | | | | | | | | | | | | | | | | | | | |
| Installation size 12 = B12 17 = B17 23 = B23 45 = RJ45 | | | | | | | | | | | | | | | | | | | | | | | |
| Shielding = unshielded S = RJ45 shielded | | | | | | | | | | | | | | | | | | | | | | | |
| Coding 1 = Coding 1 2 = Coding 2 3 = Coding 3 | | | | | | | | | | | | | | | | | | | | | | | |
| Type F = Receptacle | | | | | | | | | | | | | | | | | | | | | | | |
| Gender K = Female connector S = Male connector | | | | | | | | | | | | | | | | | | | | | | | |
| Type of installation = Front panel mounting H = Back panel mounting V = Square | | | | | | | | | | | | | | | | | | | | | | | |
| Type 1 = Long housing 2 = Short housing | | | | | | | | | | | | | | | | | | | | | | | |
| Type of power contacts Pst = Power contacts male Pbu = Power contacts female | | | | | | | | | | | | | | | | | | | | | | | |
| No. of power contacts 2 = 2-pos. (60 V) 2PE = 2-pos.+PE (600 V) 2PEA = 2-pos.+PE (250 V) 3PE = 3-pos.+PE (600 V) 4PE = 4-pos.+PE (600 V) 5PE = 2-pos.+3-pos.+PE (600 V) | | | | | | | | | | | | | | | | | | | | | | | |
| Type of data contacts Dst = Data contacts male Dbu = Data contacts female | | | | | | | | | | | | | | | | | | | | | | | |
| No. of data contacts 4 = 4-pos. 8.33 = 8-pos. (RJ45) | | | | | | | | | | | | | | | | | | | | | | | |
| Wire length power XX = Length [m] | | | | | | | | | | | | | | | | | | | | | | | |
| Cable length data XX = Length [m] | | | | | | | | | | | | | | | | | | | | | | | |
| Cable quality G6 = TPU, halogenfree, green, Cat5e, single wire quality ETFE | | | | | | | | | | | | | | | | | | | | | | | |
| Wire cross section power contact 075 = 0.75 mm ² 150 = 1.50 mm ² 250 = 2.50 mm ² 400 = 4.00 mm ² 250 + 400 = 2.50 mm ² + 4.00 mm ² | | | | | | | | | | | | | | | | | | | | | | | |
| Wire cross section data contacts 034 = 0.34 mm ² | | | | | | | | | | | | | | | | | | | | | | | |

CONEC SUPERCON HYBRID RECEPTACLES

Product specification

| Basic material | |
|------------------------|---|
| Contact | Copper alloy |
| Contact plating | Nickel plated, gold plated |
| Contact carrier | PA6, UL94 |
| Housing | CuZn, Ni |
| Sealing | NBR, FPM |
| Technical Data | |
| Rated voltage power | Size B12: 60 V DC Size B17: 250 V (2PEA), 600 V (2PE, 3PE, 4PE) |
| Rated voltage data | 24 V DC |
| Current rating power | Size B12: 10 A @ 30 °C Size B17: 20 A (2PEA), 14 A (2PE, 3PE, 4PE) @ 30 °C |
| Current rating data | 1.5 A @ 30 °C |
| Degree of protection | IP67 |
| Temperature range | -20 °C - +80 °C |
| Terminal cross section | Size B12: 0.75 mm ² + AWG22 Size B17: 2.5 mm ² + AWG22 (2PEA), 1.5 mm ² + AWG22 (2PE, 3PE, 4PE) |
| Wires | ETFE |

B12 HYBRID CONNECTORS OVERMOULDED

Connecting cable, bayonet locking

Female connector Contacts: Power = female, Ethernet = male

Female connector Contacts: Power = male, Ethernet = female

TPU, UL, halogenfree, for drag chain application

| | No. of poles | Cable length = L [m] | TPU, UL, halogenfree, for drag chain application | Description | Part No. |
|---|--------------|----------------------|--|---|----------|
|  | 2+4 | 2 | 0.75 | ENP-12-1-RKPbu2Dst4-RKPs2D-bu4-2/GAZ/075/034/A1002 | 56-07524 |
| | 2+4 | 5 | 0.75 | ENP-12-1-RKPbu2Dst4-RKPs2D-bu4-5/GAZ/075/034/A1002 | 56-07525 |
| | 2+4 | 10 | 0.75 | ENP-12-1-RKPbu2Dst4-RKPs2D-bu4-10/GAZ/075/034/A1002 | 56-07526 |

Dimension

Contacts: Power = female, Ethernet = male

Contacts: Power = male, Ethernet = female

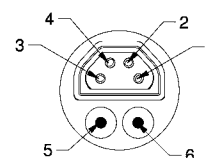
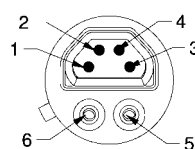
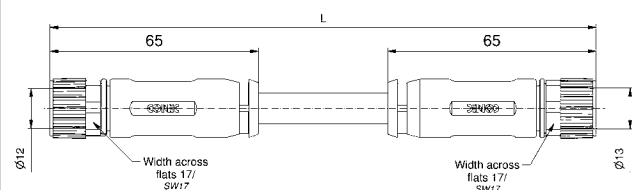

1-4: Data contacts (IEC 11801 Cat5e)
5-6: Power contacts

| Technical Data | 6-pos. (2 x 0.75 mm ² + 4 x AWG22) |
|--------------------------|--|
| Installation size | B12 |
| Coding* | 1 |
| Data contacts | 4 |
| Power contacts | 2 |
| Locking | Bayonet |
| Current rating power | 10 A @ 30 °C |
| Current rating data | 3 A @ 30 °C |
| Rated voltage power | 60 V DC |
| Rated voltage data | 24 V DC |
| Wire cross section power | 0.75 mm ² |
| Wire cross section data | AWG22 |

*Additional coding upon request

B12 HYBRID CONNECTORS FIELD ATTACHABLE

Bayonet locking

Female connector *Contacts: Power = male, Ethernet = female*

| | No. of poles | Wire cross section [mm ²] | Description | Part No. |
|---|--------------|---------------------------------------|------------------------------|----------|
|  | 2+4 | 0.75 | ENP-12-0-RKCPst2Dbu4/075/034 | 56-00009 |

Female connector *Contacts: Power = female, Ethernet = male*

| | | | | |
|--|-----|------|------------------------------|----------|
|  | 2+4 | 0.75 | ENP-12-0-RKCPbu2Dst4/075/034 | 56-00011 |
|--|-----|------|------------------------------|----------|

Dimension

Contacts: Power = male,
Ethernet = female

Contacts: Power = female,
Ethernet = male

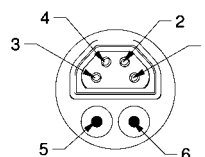
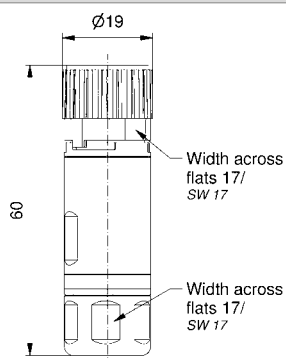

1-4: Data contacts (IEC 11801 Cat5e)
5-6: Power contacts

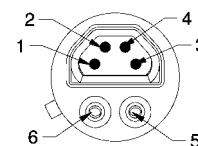

1-4: Data contacts (IEC 11801 Cat5e)
5-6: Power contacts

| Technical Data | 6-pos. (2 x 0.75 mm ² + 4 x AWG22) |
|--------------------------|--|
| Installation size | B12 |
| Coding | 1 |
| Data contacts | 4 |
| Power contacts | 2 |
| Locking | Bayonet |
| Current rating power | 10 A @ 30 °C |
| Current rating data | 3 A @ 30 °C |
| Rated voltage power | 60 V DC |
| Rated voltage data | 24 V DC |
| Wire cross section power | 0.75 mm ² |
| Wire cross section data | AWG22 |

B12 HYBRID RECEPTACLES

Back panel mounting, wire termination

Male connector Contacts: Power = male, Ethernet = female

TPU, UL, halogenfree, green, Cat5e + ETFE wire

Flange housing long version, back panel mounting

| No. of poles | Cable length = L [m] | TPU, UL, halogenfree, green, Cat5e + PVC wire | Description | Part No. |
|--------------|----------------------|---|---|----------|
| 2+4 | 0.5 | 0.75 | ENP-12-1-FSH1Pst2Dbu4-45S-RS8.33-0,5/0,5/G6/075/034 | 56-02024 |
| 2+4 | 1 | 0.75 | ENP-12-1-FSH1Pst2Dbu4-45S-RS8.33-1/1/G6/075/034 | 56-02025 |
| 2+4 | 2 | 0.75 | ENP-12-1-FSH1Pst2Dbu4-45S-RS8.33-2/2/G6/075/034 | 56-02026 |

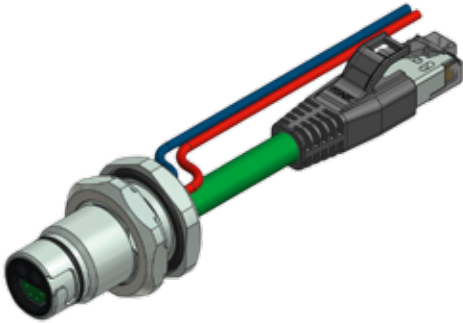

Dimension

Contacts: Power = male, Ethernet = female

RJ45

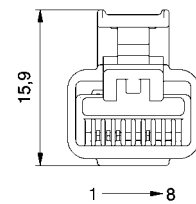
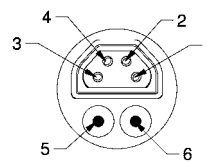
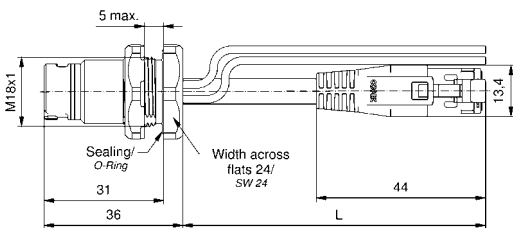

1-4: Data contacts (IEC 11801 Cat5e)
5-6: Power contacts

| Technical Data | 6-pos. (2 x 0.75 mm ² + 4 x AWG22) |
|--------------------------|--|
| Installation size | B12 |
| Coding | 1 |
| Data contacts | 4 |
| Power contacts | 2 |
| Locking | Bayonet |
| Current rating power | 10 A @ 30 °C |
| Current rating data | 1.5 A @ 30 °C |
| Rated voltage power | 60 V DC |
| Rated voltage data | 24 V DC |
| Wire cross section power | 0.75 mm ² |
| Wire cross section data | AWG22 |

B12 HYBRID RECEPTACLES

Back panel mounting, wire termination

Male connector Contacts: Power = female, Ethernet = male

TPU, UL, halogenfree, green, Cat5e + ETFE wire

Flange housing long version, back panel mounting

| No. of poles | Cable length = L [m] | TPU, UL, halogenfree, green, Cat5e + PVC wire | Description | Part No. |
|--------------|----------------------|---|---|----------|
| 2+4 | 0.5 | 0.75 | ENP-12-1-FSH1Pbu2Dst4-45S-RS8.33-0,5/0,5/G6/075/034 | 56-02030 |
| 2+4 | 1 | 0.75 | ENP-12-1-FSH1Pbu2Dst4-45S-RS8.33-1/1/G6/075/034 | 56-02031 |
| 2+4 | 2 | 0.75 | ENP-12-1-FSH1Pbu2Dst4-45S-RS8.33-2/2/G6/075/034 | 56-02032 |

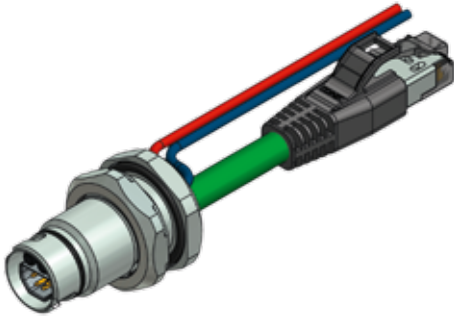

Dimension

Contacts: Power = female, Ethernet = male

RJ45

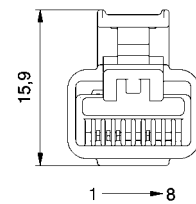
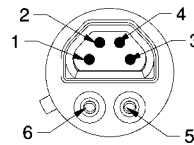
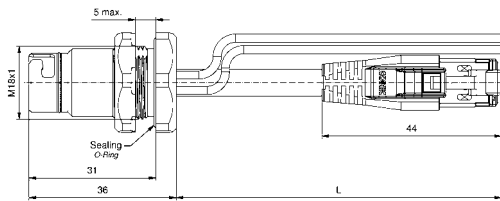

1-4: Data contacts (IEC 11801 Cat5e)
5-6: Power contacts

| Technical Data | 6-pos. (2 x 0.75 mm ² + 4 x AWG22) |
|--------------------------|--|
| Installation size | B12 |
| Coding | 1 |
| Data contacts | 4 |
| Power contacts | 2 |
| Locking | Bayonet |
| Current rating power | 10 A @ 30 °C |
| Current rating data | 1.5 A @ 30 °C |
| Rated voltage power | 60 V DC |
| Rated voltage data | 24 V DC |
| Wire cross section power | 0.75 mm ² |
| Wire cross section data | AWG22 |

B12 HYBRID RECEPTACLES

Back panel mounting, wire termination

Male connector Contacts: Power = male, Ethernet = female

TPU, UL, halogenfree, green, Cat5e + ETFE wire

Flange housing short version, back panel mounting

| No. of poles | Cable length = L [m] | TPU, UL, halogenfree, green, Cat5e + PVC wire | Description | Part No. |
|--------------|----------------------|---|---|----------|
| 2+4 | 0.5 | 0.75 | ENP-12-1-FSH2Pst2Dbu4-45S-RS8.33-0,5/0,5/G6/075/034 | 56-02060 |
| 2+4 | 1 | 0.75 | ENP-12-1-FSH2Pst2Dbu4-45S-RS8.33-1/1/G6/075/034 | 56-02061 |
| 2+4 | 2 | 0.75 | ENP-12-1-FSH2Pst2Dbu4-45S-RS8.33-2/2/G6/075/034 | 56-02062 |

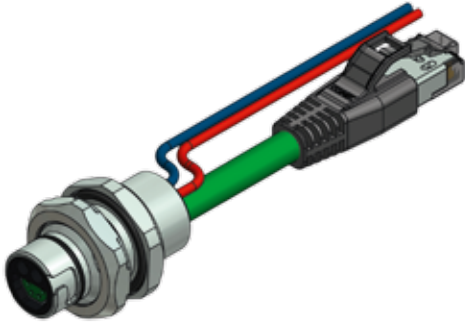

Dimension

Contacts: Power = male, Ethernet = female

RJ45

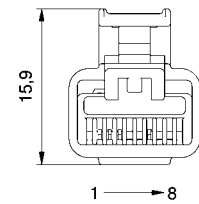
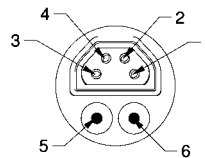
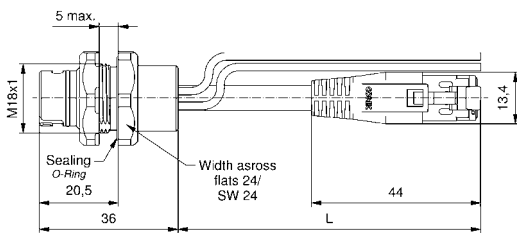

1-4: Data contacts (IEC 11801 Cat5e)
5-6: Power contacts

| Technical Data | 6-pos. (2 x 0.75 mm ² + 4 x AWG22) |
|--------------------------|--|
| Installation size | B12 |
| Coding | 1 |
| Data contacts | 4 |
| Power contacts | 2 |
| Locking | Bayonet |
| Current rating power | 10 A @ 30 °C |
| Current rating data | 1.5 A @ 30 °C |
| Rated voltage power | 60 V DC |
| Rated voltage data | 24 V DC |
| Wire cross section power | 0.75 mm ² |
| Wire cross section data | AWG22 |

B12 HYBRID RECEPTACLES

Back panel mounting, wire termination

Male connector Contacts: Power = female, Ethernet = male

TPU, UL, halogenfree, green, Cat5e + ETFE wire

Flange housing short version, back panel mounting

| No. of poles | Cable length = L [m] | TPU, UL, halogenfree, green, Cat5e + PVC wire | Description | Part No. |
|--------------|----------------------|---|---|----------|
| 2+4 | 0.5 | 0.75 | ENP-12-1-FSH2Pbu2Dst4-45S-RS8.33-0,5/0,5/G6/075/034 | 56-02066 |
| 2+4 | 1 | 0.75 | ENP-12-1-FSH2Pbu2Dst4-45S-RS8.33-1/1/G6/075/034 | 56-02067 |
| 2+4 | 2 | 0.75 | ENP-12-1-FSH2Pbu2Dst4-45S-RS8.33-2/2/G6/075/034 | 56-02068 |

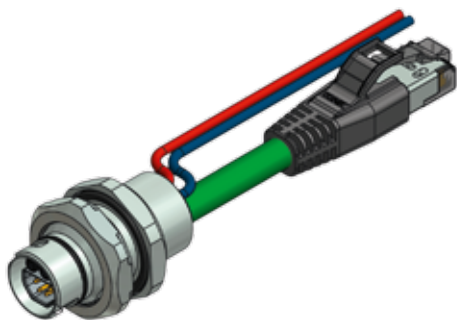

Dimension

Contacts: Power = female, Ethernet = male

RJ45

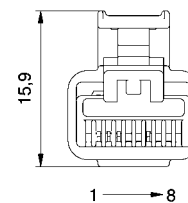
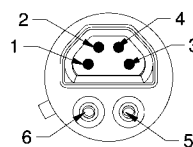
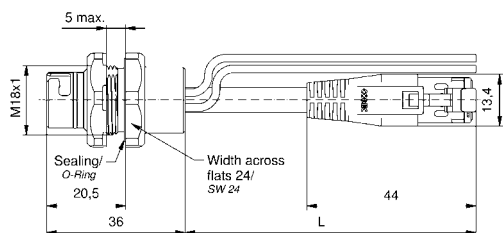

1-4: Data contacts (IEC 11801 Cat5e)
5-6: Power contacts

| Technical Data | 6-pos. (2 x 0.75 mm ² + 4 x AWG22) |
|--------------------------|--|
| Installation size | B12 |
| Coding | 1 |
| Data contacts | 4 |
| Power contacts | 2 |
| Locking | Bayonet |
| Current rating power | 10 A @ 30 °C |
| Current rating data | 1.5 A @ 30 °C |
| Rated voltage power | 60 V DC |
| Rated voltage data | 24 V DC |
| Wire cross section power | 0.75 mm ² |
| Wire cross section data | AWG22 |

B12 HYBRID RECEPTACLES

Front panel mounting, wire termination

Male connector Contacts: Power = male, Ethernet = female

TPU, UL, halogenfree, green, Cat5e + ETFE wire

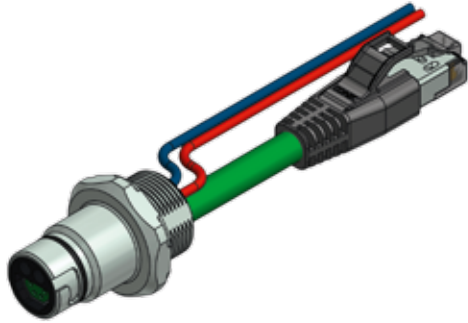

| No. of poles | Cable length = L [m] | TPU, UL, halogenfree, green, Cat5e + PVC wire | Description | Part No. |
|--------------|----------------------|---|--|----------|
| 2+4 | 0.5 | 0.75 | ENP-12-1-FS1Pst2Dbu4-45S-RS8.33-0,5/0,5/G6/075/034 | 56-02096 |
| 2+4 | 1 | 0.75 | ENP-12-1-FS1Pst2Dbu4-45S-RS8.33-1/1/G6/075/034 | 56-02097 |
| 2+4 | 2 | 0.75 | ENP-12-1-FS1Pst2Dbu4-45S-RS8.33-2/2/G6/075/034 | 56-02098 |

Dimension

Contacts: Power = male, Ethernet = female

RJ45

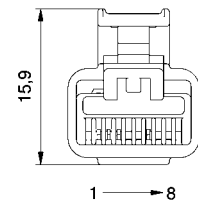
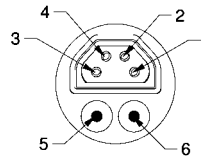
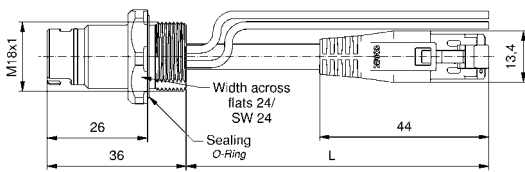

1-4: Data contacts (IEC 11801 Cat5e)
5-6: Power contacts

| Technical Data | 6-pos. (2 x 0.75 mm ² + 4 x AWG22) |
|--------------------------|--|
| Installation size | B12 |
| Coding | 1 |
| Data contacts | 4 |
| Power contacts | 2 |
| Locking | Bayonet |
| Current rating power | 10 A @ 30 °C |
| Current rating data | 1.5 A @ 30 °C |
| Rated voltage power | 60 V DC |
| Rated voltage data | 24 V DC |
| Wire cross section power | 0.75 mm ² |
| Wire cross section data | AWG22 |

B12 HYBRID RECEPTACLES

Front panel mounting, wire termination

Male connector Contacts: Power = female, Ethernet = male

TPU, UL, halogenfree, green, Cat5e + ETFE wire

Flange housing long version, front panel mounting

| No. of poles | Cable length = L [m] | TPU, UL, halogenfree, green, Cat5e + PVC wire | Description | Part No. |
|--------------|----------------------|---|--|----------|
| 2+4 | 0.5 | 0.75 | ENP-12-1-FS1Pbu2Dst4-45S-RS8.33-0,5/0,5/G6/075/034 | 56-02102 |
| 2+4 | 1 | 0.75 | ENP-12-1-FS1Pbu2Dst4-45S-RS8.33-1/1/G6/075/034 | 56-02103 |
| 2+4 | 2 | 0.75 | ENP-12-1-FS1Pbu2Dst4-45S-RS8.33-2/2/G6/075/034 | 56-02104 |

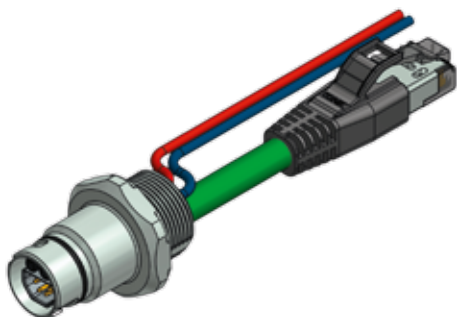

Dimension

Contacts: Power = female, Ethernet = male

RJ45

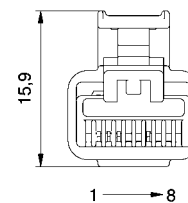
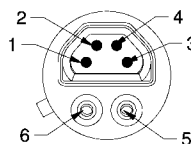
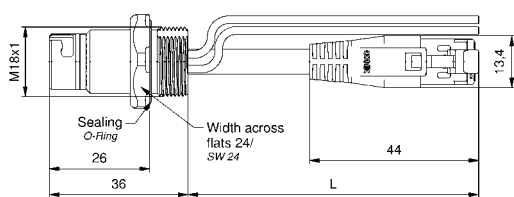

1-4: Data contacts (IEC 11801 Cat5e)
5-6: Power contacts

| Technical Data | 6-pos. (2 x 0.75 mm ² + 4 x AWG22) |
|--------------------------|--|
| Installation size | B12 |
| Coding | 1 |
| Data contacts | 4 |
| Power contacts | 2 |
| Locking | Bayonet |
| Current rating power | 10 A @ 30 °C |
| Current rating data | 1.5 A @ 30 °C |
| Rated voltage power | 60 V DC |
| Rated voltage data | 24 V DC |
| Wire cross section power | 0.75 mm ² |
| Wire cross section data | AWG22 |

B12 HYBRID RECEPTACLES

Front panel mounting, wire termination

Male connector Contacts: Power = male, Ethernet = female

Flange housing short version, front panel mounting

TPU, UL, halogenfree, green, Cat5e + ETFE wire

| No. of poles | Cable length = L [m] | TPU, UL, halogenfree, green, Cat5e + PVC wire | Description | Part No. |
|--------------|----------------------|---|--|----------|
| 2+4 | 0.5 | 0.75 | ENP-12-1-FS2Pst2Dbu4-45S-RS8.33-0,5/0,5/G6/075/034 | 56-02132 |
| 2+4 | 1 | 0.75 | ENP-12-1-FS2Pst2Dbu4-45S-RS8.33-1/1/G6/075/034 | 56-02133 |
| 2+4 | 2 | 0.75 | ENP-12-1-FS2Pst2Dbu4-45S-RS8.33-2/2/G6/075/034 | 56-02134 |

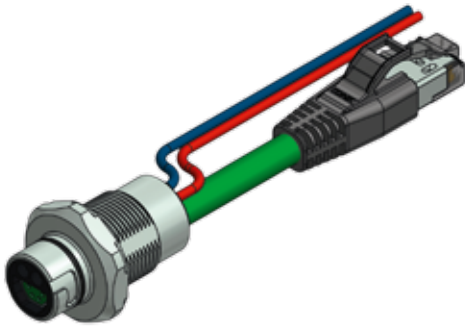

Dimension

Contacts: Power = male, Ethernet = female

RJ45

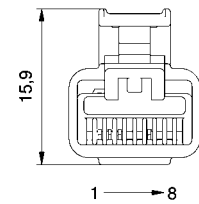
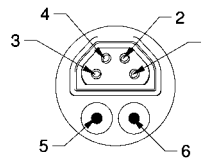
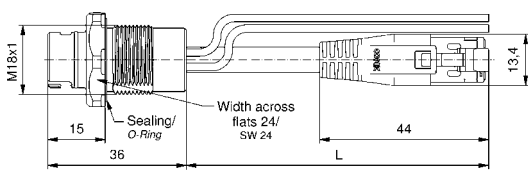

1-4: Data contacts (IEC 11801 Cat5e)
5-6: Power contacts

| Technical Data | 6-pos. (2 x 0.75 mm ² + 4 x AWG22) |
|--------------------------|--|
| Installation size | B12 |
| Coding | 1 |
| Data contacts | 4 |
| Power contacts | 2 |
| Locking | Bayonet |
| Current rating power | 10 A @ 30 °C |
| Current rating data | 1.5 A @ 30 °C |
| Rated voltage power | 60 V DC |
| Rated voltage data | 24 V DC |
| Wire cross section power | 0.75 mm ² |
| Wire cross section data | AWG22 |

B12 HYBRID RECEPTACLES
Front panel mounting, wire termination

Male connector Contacts: Power = female, Ethernet = male

TPU, UL, halogenfree, green, Cat5e + ETFE wire

Flange housing short version, front panel mounting

| No. of poles | Cable length = L [m] | TPU, UL, halogenfree, green, Cat5e + PVC wire | Description | Part No. |
|--------------|----------------------|---|--|----------|
| 2+4 | 0.5 | 0.75 | ENP-12-1-FS2Pbu2Dst4-45S-RS8.33-0,5/0,5/G6/075/034 | 56-02138 |
| 2+4 | 1 | 0.75 | ENP-12-1-FS2Pbu2Dst4-45S-RS8.33-1/1/G6/075/034 | 56-02139 |
| 2+4 | 2 | 0.75 | ENP-12-1-FS2Pbu2Dst4-45S-RS8.33-2/2/G6/075/034 | 56-02140 |

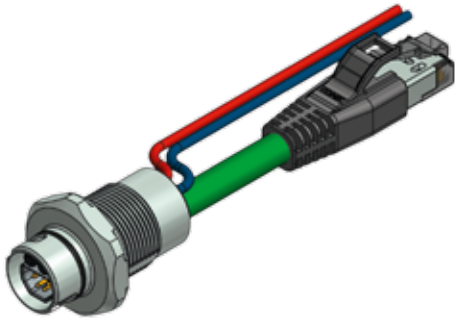

Dimension

Contacts: Power = female, Ethernet = male

RJ45

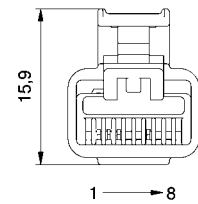
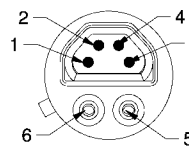
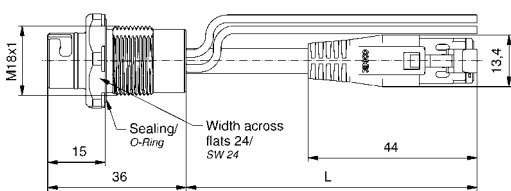

1-4: Data contacts (IEC 11801 Cat5e)
5-6: Power contacts

| Technical Data | 6-pos. (2 x 0.75 mm ² + 4 x AWG22) |
|--------------------------|--|
| Installation size | B12 |
| Coding | 1 |
| Data contacts | 4 |
| Power contacts | 2 |
| Locking | Bayonet |
| Current rating power | 10 A @ 30 °C |
| Current rating data | 1.5 A @ 30 °C |
| Rated voltage power | 60 V DC |
| Rated voltage data | 24 V DC |
| Wire cross section power | 0.75 mm ² |
| Wire cross section data | AWG22 |

B12 HYBRID RECEPTACLES

Front panel mounting, wire termination

Male connector Contacts: Power = male, Ethernet = female

TPU, UL, halogenfree, green, Cat5e + ETFE wire

Flange housing long version square, front panel mounting, 4-hole drill pattern 14 mm

| No. of poles | Cable length = L [m] | TPU, UL, halogenfree, green, Cat5e + PVC wire | Description | Part No. |
|--------------|----------------------|---|---|----------|
| 2+4 | 0.5 | 0.75 | ENP-12-1-FSV1Pst2Dbu4-45S-RS8.33-0,5/0,5/G6/075/034 | 56-02168 |
| 2+4 | 1 | 0.75 | ENP-12-1-FSV1Pst2Dbu4-45S-RS8.33-1/1/G6/075/034 | 56-02169 |
| 2+4 | 2 | 0.75 | ENP-12-1-FSV1Pst2Dbu4-45S-RS8.33-2/2/G6/075/034 | 56-02170 |

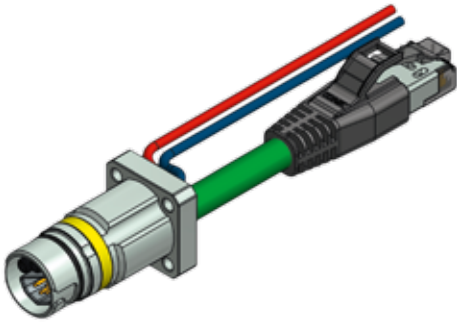

Dimension

Contacts: Power = male, Ethernet = female

RJ45

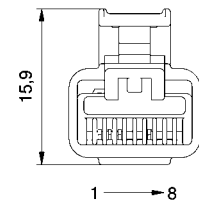
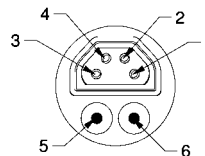
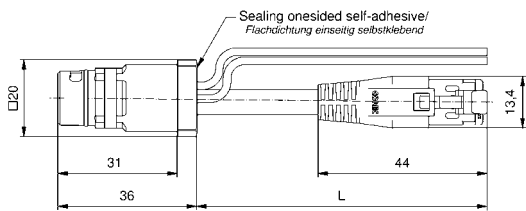

1-4: Data contacts (IEC 11801 Cat5e)
5-6: Power contacts

| Technical Data | 6-pos. (2 x 0.75 mm ² + 4 x AWG22) |
|--------------------------|--|
| Installation size | B12 |
| Coding | 1 |
| Data contacts | 4 |
| Power contacts | 2 |
| Locking | Bayonet |
| Current rating power | 10 A @ 30 °C |
| Current rating data | 1.5 A @ 30 °C |
| Rated voltage power | 60 V DC |
| Rated voltage data | 24 V DC |
| Wire cross section power | 0.75 mm ² |
| Wire cross section data | AWG22 |

B12 HYBRID RECEPTACLES

Front panel mounting, wire termination

Male connector Contacts: Power = female, Ethernet = male

TPU, UL, halogenfree, green, Cat5e + ETFE wire

Flange housing long version square, front panel mounting, 4-hole drill pattern 14 mm

| No. of poles | Cable length = L [m] | TPU, UL, halogenfree, green, Cat5e + PVC wire | Description | Part No. |
|--------------|----------------------|---|---|----------|
| 2+4 | 0.5 | 0.75 | ENP-12-1-FSV1Pbu2Dst4-45S-RS8.33-0,5/0,5/G6/075/034 | 56-02174 |
| 2+4 | 1 | 0.75 | ENP-12-1-FSV1Pbu2Dst4-45S-RS8.33-1/1/G6/075/034 | 56-02175 |
| 2+4 | 2 | 0.75 | ENP-12-1-FSV1Pbu2Dst4-45S-RS8.33-2/2/G6/075/034 | 56-02176 |

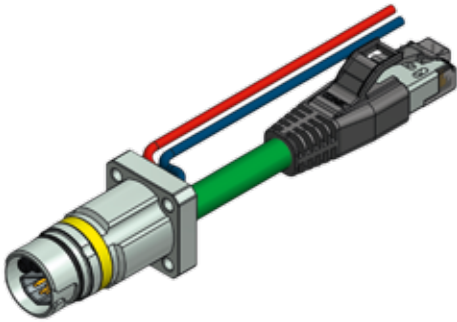

Dimension

Contacts: Power = female, Ethernet = male

RJ45

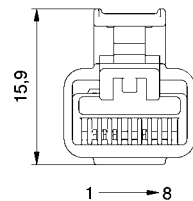
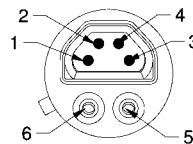
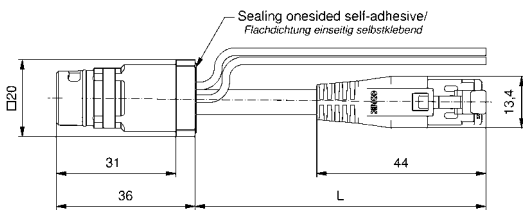

1-4: Data contacts (IEC 11801 Cat5e)
5-6: Power contacts

| Technical Data | 6-pos. (2 x 0.75 mm ² + 4 x AWG22) |
|--------------------------|--|
| Installation size | B12 |
| Coding | 1 |
| Data contacts | 4 |
| Power contacts | 2 |
| Locking | Bayonet |
| Current rating power | 10 A @ 30 °C |
| Current rating data | 1.5 A @ 30 °C |
| Rated voltage power | 60 V DC |
| Rated voltage data | 24 V DC |
| Wire cross section power | 0.75 mm ² |
| Wire cross section data | AWG22 |

B12 HYBRID RECEPTACLES

Front panel mounting, wire termination

Male connector Contacts: Power = male, Ethernet = female

TPU, UL, halogenfree, green, Cat5e + ETFE wire

Flange housing short version square, front panel mounting, 4-hole drill pattern 14 mm

| No. of poles | Cable length = L [m] | TPU, UL, halogenfree, green, Cat5e + PVC wire | Description | Part No. |
|--------------|----------------------|---|---|----------|
| 2+4 | 0.5 | 0.75 | ENP-12-1-FSV2Pst2Dbu4-45S-RS8.33-0,5/0,5/G6/075/034 | 56-02204 |
| 2+4 | 1 | 0.75 | ENP-12-1-FSV2Pst2Dbu4-45S-RS8.33-1/1/G6/075/034 | 56-02205 |
| 2+4 | 2 | 0.75 | ENP-12-1-FSV2Pst2Dbu4-45S-RS8.33-2/2/G6/075/034 | 56-02206 |

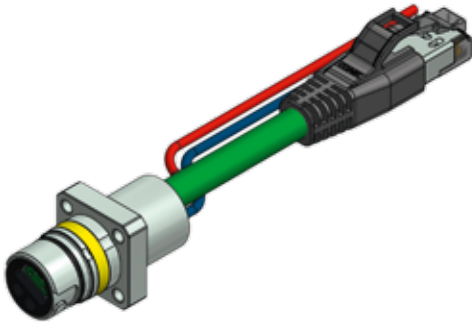

Dimension

Contacts: Power = male, Ethernet = female

RJ45

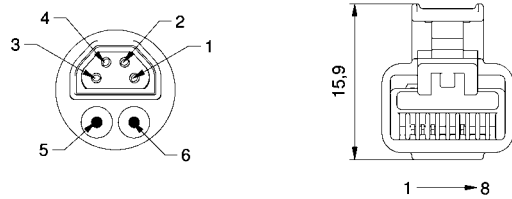
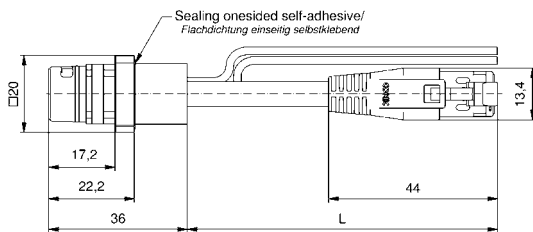

1-4: Data contacts (IEC 11801 Cat5e)
5-6: Power contacts

| Technical Data | 6-pos. (2 x 0.75 mm ² + 4 x AWG22) |
|--------------------------|--|
| Installation size | B12 |
| Coding | 1 |
| Data contacts | 4 |
| Power contacts | 2 |
| Locking | Bayonet |
| Current rating power | 10 A @ 30 °C |
| Current rating data | 1.5 A @ 30 °C |
| Rated voltage power | 60 V DC |
| Rated voltage data | 24 V DC |
| Wire cross section power | 0.75 mm ² |
| Wire cross section data | AWG22 |

B12 HYBRID RECEPTACLES

Front panel mounting, wire termination

Male connector Contacts: Power = female, Ethernet = male

TPU, UL, halogenfree, green, Cat5e + ETFE wire

Flange housing short version square, front panel mounting, 4-hole drill pattern 14 mm

| No. of poles | Cable length = L [m] | TPU, UL, halogenfree, green, Cat5e + PVC wire | Description | Part No. |
|--------------|----------------------|---|---|----------|
| 2+4 | 0.5 | 0.75 | ENP-12-1-FSV2Pbu2Dst4-45S-RS8.33-0,5/0,5/G6/075/034 | 56-02210 |
| 2+4 | 1 | 0.75 | ENP-12-1-FSV2Pbu2Dst4-45S-RS8.33-1/1/G6/075/034 | 56-02211 |
| 2+4 | 2 | 0.75 | ENP-12-1-FSV2Pbu2Dst4-45S-RS8.33-2/2/G6/075/034 | 56-02212 |

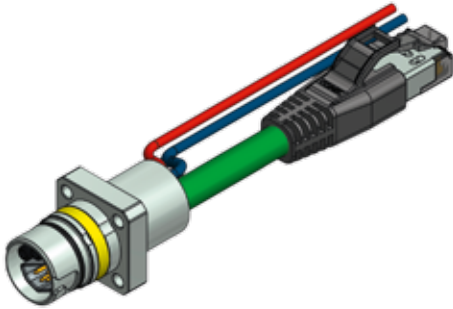

Dimension

Contacts: Power = female, Ethernet = male

RJ45

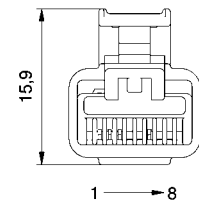
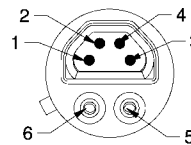
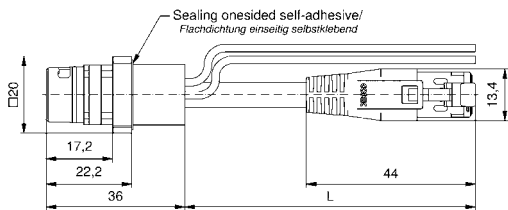

1-4: Data contacts (IEC 11801 Cat5e)
5-6: Power contacts

| Technical Data | 6-pos. (2 x 0.75 mm ² + 4 x AWG22) |
|--------------------------|--|
| Installation size | B12 |
| Coding | 1 |
| Data contacts | 4 |
| Power contacts | 2 |
| Locking | Bayonet |
| Current rating power | 10 A @ 30 °C |
| Current rating data | 1.5 A @ 30 °C |
| Rated voltage power | 60 V DC |
| Rated voltage data | 24 V DC |
| Wire cross section power | 0.75 mm ² |
| Wire cross section data | AWG22 |

B17 HYBRID CONNECTORS OVERMOULDED

Connecting cable, bayonet locking

Female connector Contacts: Power = female, Ethernet = male

Female connector Contacts: Power = male, Ethernet = female

TPU, UL, halogenfree, for drag chain application



| No. of poles | Cable length = L [m] | TPU, UL, halogenfree, for drag chain application | Description | Part No. |
|--------------|----------------------|--|---|------------|
| 3+4 | 2 | 1.5 | ENP-17-1-RKPbu2PEDst4-RKPst2PED-bu4-2/GAZ/150/034/A1002 | 57-07644 |
| 3+4 | 5 | 1.5 | ENP-17-1-RKPbu2PEDst4-RKPst2PED-bu4-5/GAZ/150/034/A1002 | 57-07645 |
| 3+4 | 10 | 1.5 | ENP-17-1-RKPbu2PEDst4-RKPst2PED-bu4-10/GAZ/150/034/A1002 | 57-07646 |
| 3+4 | 2 | 2.5 | ENP-17-1-RKPbu2PEADst4-RKPst2PED-bu4-2/GAZ/250/034/A1002 | 57-07653 |
| 3+4 | 5 | 2.5 | ENP-17-1-RKPbu2PEADst4-RKPst2PED-bu4-5/GAZ/250/034/A1002 | 57-07654 |
| 3+4 | 10 | 2.5 | ENP-17-1-RKPbu2PEADst4-RKPst2PED-bu4-10/GAZ/250/034/A1002 | 57-07655 |
| 4+4 | 2 | 1.5 | ENP-17-1-RKPbu3PEDst4-RKPst2PED-bu4-2/GAZ/150/034/A1002 | 57-07662** |
| 4+4 | 5 | 1.5 | ENP-17-1-RKPbu3PEDst4-RKPst2PED-bu4-5/GAZ/150/034/A1002 | 57-07663** |
| 4+4 | 10 | 1.5 | ENP-17-1-RKPbu3PEDst4-RKPst2PED-bu4-10/GAZ/150/034/A1002 | 57-07664** |
| 5+4 | 2 | 1.5 | ENP-17-1-RKPbu4PEDst4-RKPst2PED-bu4-2/GAZ/150/034/A1002 | 57-07671 |
| 5+4 | 5 | 1.5 | ENP-17-1-RKPbu4PEDst4-RKPst2PED-bu4-5/GAZ/150/034/A1002 | 57-07672 |
| 5+4 | 10 | 1.5 | ENP-17-1-RKPbu4PEDst4-RKPst2PED-bu4-10/GAZ/150/034/A1002 | 57-07673 |

Dimension

Contacts: Power = female, Ethernet = male

Contacts: Power = male, Ethernet = female

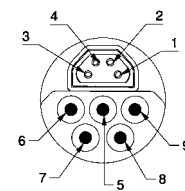
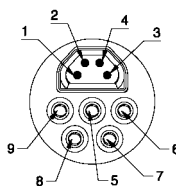
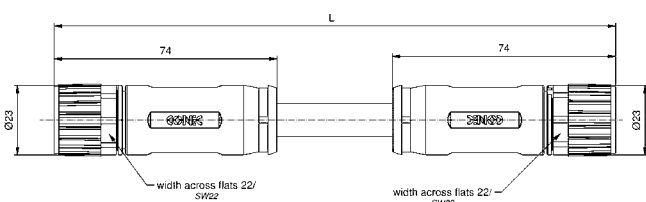

1-4: Data contacts (IEC 11801 Cat5e)
5-9: Power contacts

| Technical Data | 7-pos. (3 x 1.5 mm ² + 4 x AWG22) | 7-pos. (3 x 2.5 mm ² + 4 x AWG22) | 8-pos.** (4 x 1.5 mm ² + 4 x AWG22) | 9-pos. (5 x 1.5 mm ² + 4 x AWG22) |
|--------------------------|---|---|---|---|
| Installation size | B17 | B17 | B17 | B17 |
| Coding | 1 | 1 | 1 | 1 |
| Data contacts | 4 | 4 | 4 | 4 |
| Power contacts | 2+PE | 2+PE | 3+PE | 4+PE |
| Locking | Bayonet | Bayonet | Bayonet | Bayonet |
| Current rating power | 14 A @ 30 °C | 20 A @ 30 °C | 14 A @ 30 °C | 14 A @ 30 °C |
| Current rating data | 3 A @ 30 °C | 3 A @ 30 °C | 3 A @ 30 °C | 3 A @ 30 °C |
| Rated voltage power | 600 AC/DC | 250 AC/DC | 600 AC/DC | 600 AC/DC |
| Rated voltage data | 24 V DC | 24 V DC | 24 V DC | 24 V DC |
| Wire cross section power | 1.5 mm ² | 2.5 mm ² | 1.5 mm ² | 1.5 mm ² |
| Wire cross section data | AWG22 | AWG22 | AWG22 | AWG22 |

*Additional coding upon request **on request

B17 HYBRID CONNECTORS FIELD ATTACHABLE

Bayonet locking

Female connector Contacts: Power = male, Ethernet = female

| | No. of poles | Wire cross section [mm ²] | Description | |
|---|--------------|---------------------------------------|----------------------------------|-----------|
| | | | Description | Part No. |
|  | 3+4 | 1.5 | ENP-17-0-RKCPst2PED-bu4/150/034 | 57-00017 |
| | 3+4 | 2.5 | ENP-17-0-RKCPst2PEAD-bu4/250/034 | 57-00018 |
| | 4+4 | 1.5 | ENP-17-0-RKCPst3PED-bu4/150/034 | 57-00019* |
| | 5+4 | 1.5 | ENP-17-0-RKCPst4PED-bu4/150/034 | 57-00020 |

Dimension

Contacts: Power = male,
Ethernet = female

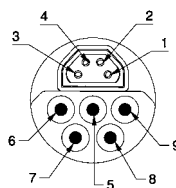
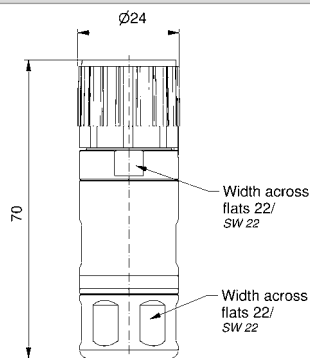

1-4: Data contacts (IEC 11801 Cat5e)
5-9: Power contacts

| Technical Data | 7-pos. (3 x 1.5 mm ² + 4 x AWG22) | 7-pos. (3 x 2.5 mm ² + 4 x AWG22) | 8-pos.* (4 x 1.5 mm ² + 4 x AWG22) | 9-pos. (4 x 1.5 mm ² + 4 x AWG22) |
|--------------------------|---|---|--|---|
| Installation size | B17 | B17 | B17 | B17 |
| Coding | 1 | 1 | 1 | 1 |
| Data contacts | 4 | 4 | 4 | 4 |
| Power contacts | 2+PE | 2+PE | 2+PE | 2+PE |
| Locking | Bayonet | Bayonet | Bayonet | Bayonet |
| Current rating power | 14 A @ 30 °C | 20 A @ 30 °C | 14 A @ 30 °C | 14 A @ 30 °C |
| Current rating data | 3 A @ 30 °C | 3 A @ 30 °C | 3 A @ 30 °C | 3 A @ 30 °C |
| Rated voltage power | 600 AC/DC | 250 AC/DC | 600 AC/DC | 600 AC/DC |
| Rated voltage data | 24 V DC | 24 V DC | 24 V DC | 24 V DC |
| Wire cross section power | 1.5 mm ² | 2.5 mm ² | 1.5 mm ² | 2.5 mm ² |
| Wire cross section data | AWG22 | AWG22 | AWG22 | AWG22 |

*on request

B17 HYBRID CONNECTORS FIELD ATTACHABLE Bayonet locking

Female connector Contacts: Power = female, Ethernet = male



| | No. of poles | Wire cross section [mm ²] | Description | Part No. |
|--|--------------|---------------------------------------|----------------------------------|-----------|
| | 3+4 | 2.5 | ENP-17-0-RKCPbu-2PEDst4/150/034 | 57-00021 |
| | 3+4 | 1.5 | ENP-17-0-RKCPbu-2PEADst4/250/034 | 57-00022 |
| | 4+4 | 1.5 | ENP-17-0-RKCPbu-2PEDst4/150/034 | 57-00023* |
| | 5+4 | 1.5 | ENP-17-0-RKCPbu-2PEDst4/150/034 | 57-00024 |

Dimension

Contacts: Power = female,
Ethernet = male

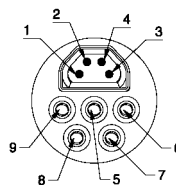
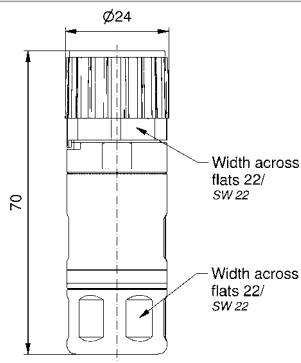

1-4: Data contacts (IEC 11801 Cat5e)
5-9: Power contacts

| Technical Data | 7-pos. (3 x 1.5 mm ² + 4 x AWG22) | 7-pos. (3 x 2.5 mm ² + 4 x AWG22) | 8-pos.* (4 x 1.5 mm ² + 4 x AWG22) | 9-pos. (5 x 1.5 mm ² + 4 x AWG22) |
|--------------------------|---|---|--|---|
| Installation size | B17 | B17 | B17 | B17 |
| Coding | 1 | 1 | 1 | 1 |
| Data contacts | 4 | 4 | 4 | 4 |
| Power contacts | 2+PE | 2+PE | 3+PE | 3+PE |
| Locking | Bayonet | Bayonet | Bayonet | Bayonet |
| Current rating power | 14 A @ 30 °C | 20 A @ 30 °C | 14 A @ 30 °C | 14 A @ 30 °C |
| Current rating data | 3 A @ 30 °C | 3 A @ 30 °C | 3 A @ 30 °C | 3 A @ 30 °C |
| Rated voltage power | 600 AC/DC | 250 AC/DC | 600 AC/DC | 600 AC/DC |
| Rated voltage data | 24 V DC | 24 V DC | 24 V DC | 24 V DC |
| Wire cross section power | 2.5 mm ² | 2.5 mm ² | 1.5 mm ² | 1.5 mm ² |
| Wire cross section data | AWG22 | AWG22 | AWG22 | AWG22 |

*on request

B17 HYBRID RECEPTACLES

Back panel mounting, wire termination

Male connector Contacts: Power = male, Ethernet = female

TPU, UL, halogenfree, green, Cat5e + ETFE wire

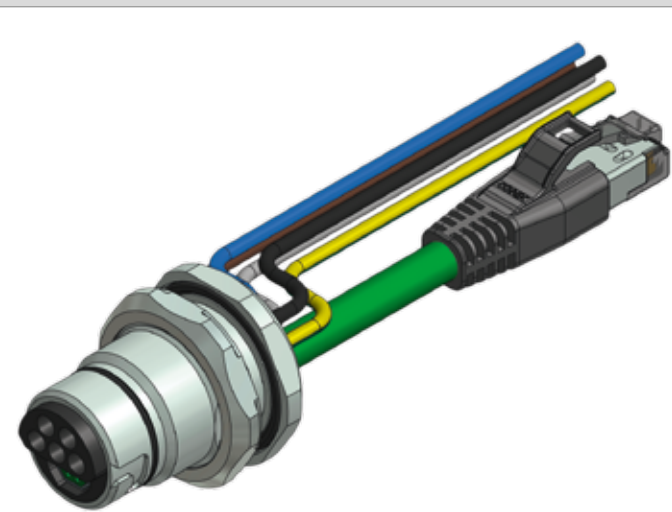

| No. of poles | Cable length = L [m] | TPU, UL, halogenfree, green, Cat5e + PVC wire | Description | Part No. |
|--------------|----------------------|---|--|-----------|
| 3+4 | 0.5 | 1.5 | ENP-17-1-FSH1Pst2PEDbu4-45S-RS8.33-0,5/0,5/G6/150/034 | 57-02144 |
| 3+4 | 1 | 1.5 | ENP-17-1-FSH1Pst2PEDbu4-45S-RS8.33-1/1/G6/150/034 | 57-02145 |
| 3+4 | 2 | 1.5 | ENP-17-1-FSH1Pst2PEDbu4-45S-RS8.33-2/2/G6/150/034 | 57-02146 |
| 3+4 | 0.5 | 2.5 | ENP-17-1-FSH1Pst2PEADbu4-45S-RS8.33-0,5/0,5/G6/250/034 | 57-02153 |
| 3+4 | 1 | 2.5 | ENP-17-1-FSH1Pst2PEADbu4-45S-RS8.33-1/1/G6/250/034 | 57-02154 |
| 3+4 | 2 | 2.5 | ENP-17-1-FSH1Pst2PEADbu4-45S-RS8.33-2/2/G6/250/034 | 57-02155 |
| 4+4 | 0.5 | 1.5 | ENP-17-1-FSH1Pst3PEDbu4-45S-RS8.33-0,5/0,5/G6/150/034 | 57-02162* |
| 4+4 | 1 | 1.5 | ENP-17-1-FSH1Pst3PEDbu4-45S-RS8.33-1/1/G6/150/034 | 57-02163* |
| 4+4 | 2 | 1.5 | ENP-17-1-FSH1Pst3PEDbu4-45S-RS8.33-2/2/G6/150/034 | 57-02164* |
| 5+4 | 0.5 | 1.5 | ENP-17-1-FSH1Pst4PEDbu4-45S-RS8.33-0,5/0,5/G6/150/034 | 57-02171 |
| 5+4 | 1 | 1.5 | ENP-17-1-FSH1Pst4PEDbu4-45S-RS8.33-1/1/G6/150/034 | 57-02172 |
| 5+4 | 2 | 1.5 | ENP-17-1-FSH1Pst4PEDbu4-45S-RS8.33-2/2/G6/150/034 | 57-02173 |

Flange housing long version, back panel mounting

Dimension

Contacts: Power = male, Ethernet = female

RJ45

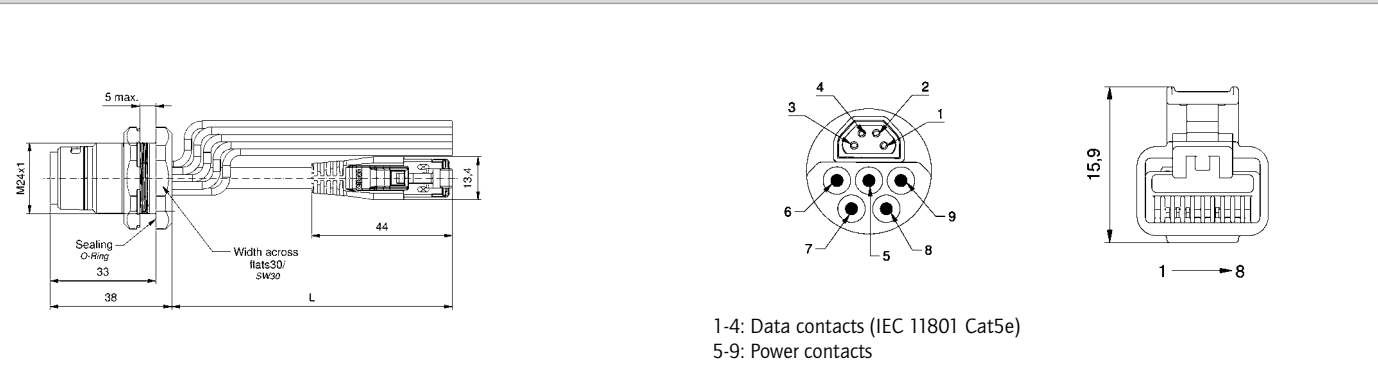

1-4: Data contacts (IEC 11801 Cat5e)
5-9: Power contacts

| Technical Data | 7-pos. (3 x 1.5 mm ² + 4 x AWG22) | 7-pos. (3 x 2.5 mm ² + 4 x AWG22) | 8-pos.* (4 x 1.5 mm ² + 4 x AWG22) | 9-pos. (5 x 1.5 mm ² + 4 x AWG22) |
|--------------------------|---|---|--|---|
| Installation size | B17 | B17 | B17 | B17 |
| Coding | 1 | 1 | 1 | 1 |
| Data contacts | 4 | 4 | 4 | 4 |
| Power contacts | 2+PE | 2+PE | 3+PE | 4+PE |
| Locking | Bayonet | Bayonet | Bayonet | Bayonet |
| Current rating power | 14 A @ 30 °C | 20 A @ 30 °C | 14 A @ 30 °C | 14 A @ 30 °C |
| Current rating data | 1.5 A @ 30 °C | 1.5 A @ 30 °C | 1.5 A @ 30 °C | 1.5 A @ 30 °C |
| Rated voltage power | 600 AC/DC | 250 AC/DC | 600 AC/DC | 600 AC/DC |
| Rated voltage data | 24 V DC | 24 V DC | 24 V DC | 24 V DC |
| Wire cross section power | 1.5 mm ² | 2.5 mm ² | 1.5 mm ² | 1.5 mm ² |
| Wire cross section data | AWG22 | AWG22 | AWG22 | AWG22 |

*on request

B17 HYBRID RECEPTACLES

Back panel mounting, wire termination

Male connector Contacts: Power = female, Ethernet = male

TPU, UL, halogenfree, green, Cat5e + ETFE wire

Flange housing long version, back panel mounting

| No. of poles | Cable length = L [m] | TPU, UL, halogenfree, green, Cat5e + PVC wire | Description | Part No. |
|--------------|----------------------|---|--|-----------|
| 3+4 | 0.5 | 1.5 | ENP-17-1-FSH1Pbu2PEDst4-45S-RS8.33-0,5/0,5/G6/150/034 | 57-02180 |
| 3+4 | 1 | 1.5 | ENP-17-1-FSH1Pbu2PEDst4-45S-RS8.33-1/1/G6/150/034 | 57-02181 |
| 3+4 | 2 | 1.5 | ENP-17-1-FSH1Pbu2PEDst4-45S-RS8.33-2/2/G6/150/034 | 57-02182 |
| 3+4 | 0.5 | 2.5 | ENP-17-1-FSH1Pbu2PEADst4-45S-RS8.33-0,5/0,5/G6/250/034 | 57-02189 |
| 3+4 | 1 | 2.5 | ENP-17-1-FSH1Pbu2PEADst4-45S-RS8.33-1/1/G6/250/034 | 57-02190 |
| 3+4 | 2 | 2.5 | ENP-17-1-FSH1Pbu2PEADst4-45S-RS8.33-2/2/G6/250/034 | 57-02191 |
| 4+4 | 0.5 | 1.5 | ENP-17-1-FSH1Pbu3PEDst4-45S-RS8.33-0,5/0,5/G6/150/034 | 57-02198* |
| 4+4 | 1 | 1.5 | ENP-17-1-FSH1Pbu3PEDst4-45S-RS8.33-1/1/G6/150/034 | 57-02199* |
| 4+4 | 2 | 1.5 | ENP-17-1-FSH1Pbu3PEDst4-45S-RS8.33-2/2/G6/150/034 | 57-02200* |
| 5+4 | 0.5 | 1.5 | ENP-17-1-FSH1Pbu4PEDst4-45S-RS8.33-0,5/0,5/G6/150/034 | 57-02207 |
| 5+4 | 1 | 1.5 | ENP-17-1-FSH1Pbu4PEDst4-45S-RS8.33-1/1/G6/150/034 | 57-02208 |
| 5+4 | 2 | 1.5 | ENP-17-1-FSH1Pbu4PEDst4-45S-RS8.33-2/2/G6/150/034 | 57-02209 |

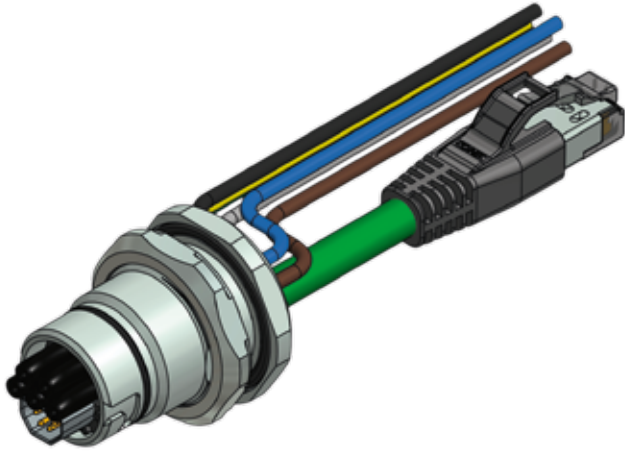

Dimension

Contacts: Power = female, Ethernet = male

RJ45

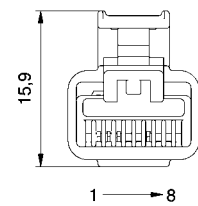
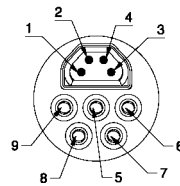
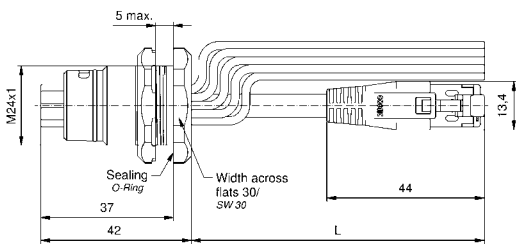

1-4: Data contacts (IEC 11801 Cat5e)
5-9: Power contacts

| Technical Data | 7-pos. (3 x 1.5 mm ² + 4 x AWG22) | 7-pos. (3 x 2.5 mm ² + 4 x AWG22) | 8-pos.* (4 x 1.5 mm ² + 4 x AWG22) | 9-pos. (5 x 1.5 mm ² + 4 x AWG22) |
|--------------------------|---|---|--|---|
| Installation size | B17 | B17 | B17 | B17 |
| Coding | 1 | 1 | 1 | 1 |
| Data contacts | 4 | 4 | 4 | 4 |
| Power contacts | 2+PE | 2+PE | 3+PE | 4+PE |
| Locking | Bayonet | Bayonet | Bayonet | Bayonet |
| Current rating power | 14 A @ 30 °C | 20 A @ 30 °C | 14 A @ 30 °C | 14 A @ 30 °C |
| Current rating data | 1.5 A @ 30 °C | 1.5 A @ 30 °C | 1.5 A @ 30 °C | 1.5 A @ 30 °C |
| Rated voltage power | 600 AC/DC | 250 AC/DC | 600 AC/DC | 600 AC/DC |
| Rated voltage data | 24 V DC | 24 V DC | 24 V DC | 24 V DC |
| Wire cross section power | 1.5 mm ² | 2.5 mm ² | 1.5 mm ² | 1.5 mm ² |
| Wire cross section data | AWG22 | AWG22 | AWG22 | AWG22 |

*on request

B17 HYBRID RECEPTACLES

Back panel mounting, wire termination

Male connector Contacts: Power = male, Ethernet = female

TPU, UL, halogenfree, green, Cat5e + ETFE wire

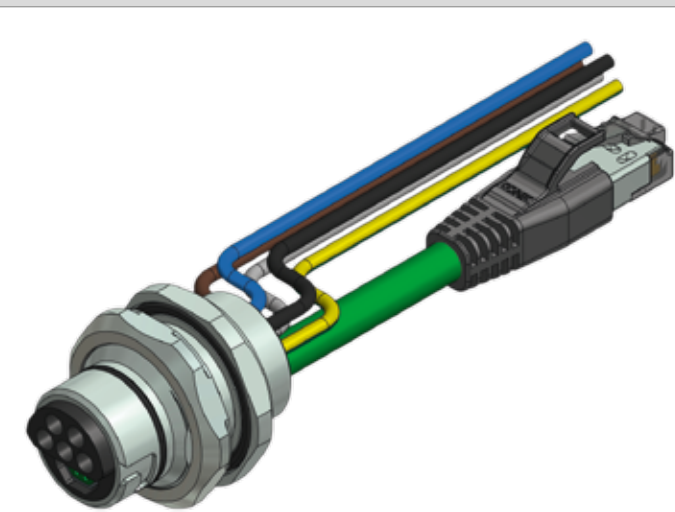

| No. of poles | Cable length = L [m] | TPU, UL, halogenfree, green, Cat5e + PVC wire | Flange housing short version, back panel mounting | Description | Part No. |
|--------------|----------------------|---|---|--|-----------|
| 3+4 | 0.5 | 1.5 | | ENP-17-1-FSH2Pst2PEDbu4-45S-RS8.33-0,5/0,5/G6/150/034 | 57-02360 |
| 3+4 | 1 | 1.5 | | ENP-17-1-FSH2Pst2PEDbu4-45S-RS8.33-1/1/G6/150/034 | 57-02361 |
| 3+4 | 2 | 1.5 | | ENP-17-1-FSH2Pst2PEDbu4-45S-RS8.33-2/2/G6/150/034 | 57-02362 |
| 3+4 | 0.5 | 2.5 | | ENP-17-1-FSH2Pst2PEADbu4-45S-RS8.33-0,5/0,5/G6/250/034 | 57-02369 |
| 3+4 | 1 | 2.5 | | ENP-17-1-FSH2Pst2PEADbu4-45S-RS8.33-1/1/G6/250/034 | 57-02370 |
| 3+4 | 2 | 2.5 | | ENP-17-1-FSH2Pst2PEADbu4-45S-RS8.33-2/2/G6/250/034 | 57-02371 |
| 4+4 | 0.5 | 1.5 | | ENP-17-1-FSH2Pst3PEDbu4-45S-RS8.33-0,5/0,5/G6/150/034 | 57-02378* |
| 4+4 | 1 | 1.5 | | ENP-17-1-FSH2Pst3PEDbu4-45S-RS8.33-1/1/G6/150/034 | 57-02379* |
| 4+4 | 2 | 1.5 | | ENP-17-1-FSH2Pst3PEDbu4-45S-RS8.33-2/2/G6/150/034 | 57-02380* |
| 5+4 | 0.5 | 1.5 | | ENP-17-1-FSH2Pst4PEDbu4-45S-RS8.33-0,5/0,5/G6/150/034 | 57-02387 |
| 5+4 | 1 | 1.5 | | ENP-17-1-FSH2Pst4PEDbu4-45S-RS8.33-1/1/G6/150/034 | 57-02388 |
| 5+4 | 2 | 1.5 | | ENP-17-1-FSH2Pst4PEDbu4-45S-RS8.33-2/2/G6/150/034 | 57-02389 |

Dimension

Contacts: Power = male, Ethernet = female

RJ45

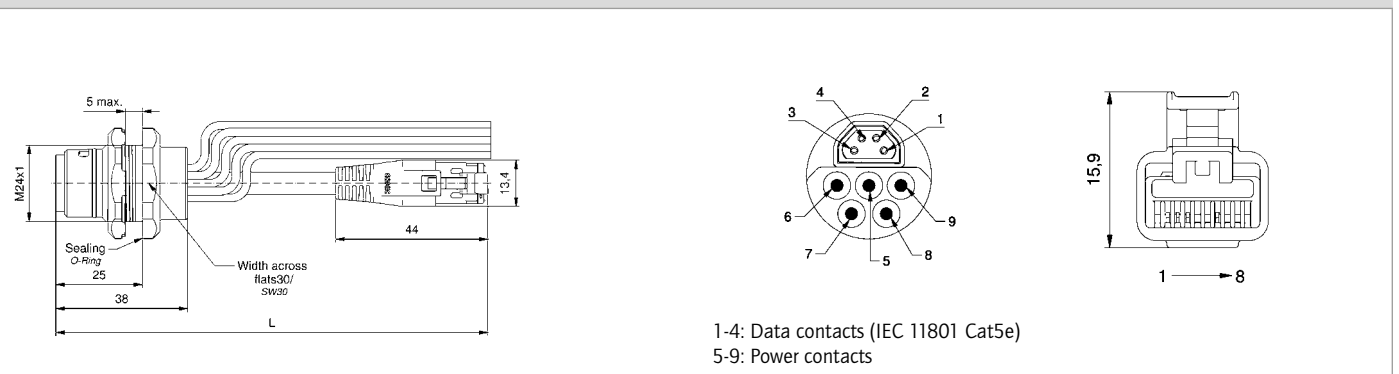

1-4: Data contacts (IEC 11801 Cat5e)
5-9: Power contacts

| Technical Data | 7-pos. (3 x 1.5 mm ² + 4 x AWG22) | 7-pos. (3 x 2.5 mm ² + 4 x AWG22) | 8-pos.* (4 x 1.5 mm ² + 4 x AWG22) | 9-pos. (5 x 1.5 mm ² + 4 x AWG22) |
|--------------------------|---|---|--|---|
| Installation size | B17 | B17 | B17 | B17 |
| Coding | 1 | 1 | 1 | 1 |
| Data contacts | 4 | 4 | 4 | 4 |
| Power contacts | 2+PE | 2+PE | 3+PE | 4+PE |
| Locking | Bayonet | Bayonet | Bayonet | Bayonet |
| Current rating power | 14 A @ 30 °C | 20 A @ 30 °C | 14 A @ 30 °C | 14 A @ 30 °C |
| Current rating data | 1.5 A @ 30 °C | 1.5 A @ 30 °C | 1.5 A @ 30 °C | 1.5 A @ 30 °C |
| Rated voltage power | 600 AC/DC | 250 AC/DC | 600 AC/DC | 600 AC/DC |
| Rated voltage data | 24 V DC | 24 V DC | 24 V DC | 24 V DC |
| Wire cross section power | 1.5 mm ² | 2.5 mm ² | 1.5 mm ² | 1.5 mm ² |
| Wire cross section data | AWG22 | AWG22 | AWG22 | AWG22 |

*on request

B17 HYBRID RECEPTACLES

Back panel mounting, wire termination

Male connector Contacts: Power = female, Ethernet = male

TPU, UL, halogenfree, green, Cat5e + ETFE wire

Flange housing short version, back panel mounting

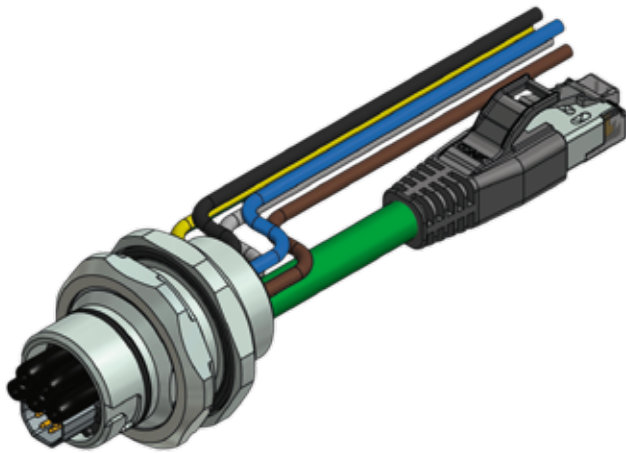

| No. of poles | Cable length = L [m] | TPU, UL, halogenfree, green, Cat5e + PVC wire | Description | Part No. |
|--------------|----------------------|---|--|-----------|
| 3+4 | 0.5 | 1.5 | ENP-17-1-FSH2Pbu2PEDst4-45S-RS8.33-0,5/0,5/G6/150/034 | 57-02396 |
| 3+4 | 1 | 1.5 | ENP-17-1-FSH2Pbu2PEDst4-45S-RS8.33-1/1/G6/150/034 | 57-02397 |
| 3+4 | 2 | 1.5 | ENP-17-1-FSH2Pbu2PEDst4-45S-RS8.33-2/2/G6/150/034 | 57-02398 |
| 3+4 | 0.5 | 2.5 | ENP-17-1-FSH2Pbu2PEADst4-45S-RS8.33-0,5/0,5/G6/250/034 | 57-02405 |
| 3+4 | 1 | 2.5 | ENP-17-1-FSH2Pbu2PEADst4-45S-RS8.33-1/1/G6/250/034 | 57-02406 |
| 3+4 | 2 | 2.5 | ENP-17-1-FSH2Pbu2PEADst4-45S-RS8.33-2/2/G6/250/034 | 57-02407 |
| 4+4 | 0.5 | 1.5 | ENP-17-1-FSH2Pbu3PEDst4-45S-RS8.33-0,5/0,5/G6/150/034 | 57-02414* |
| 4+4 | 1 | 1.5 | ENP-17-1-FSH2Pbu3PEDst4-45S-RS8.33-1/1/G6/150/034 | 57-02415* |
| 4+4 | 2 | 1.5 | ENP-17-1-FSH2Pbu3PEDst4-45S-RS8.33-2/2/G6/150/034 | 57-02416* |
| 5+4 | 0.5 | 1.5 | ENP-17-1-FSH2Pbu4PEDst4-45S-RS8.33-0,5/0,5/G6/150/034 | 57-02423 |
| 5+4 | 1 | 1.5 | ENP-17-1-FSH2Pbu4PEDst4-45S-RS8.33-1/1/G6/150/034 | 57-02424 |
| 5+4 | 2 | 1.5 | ENP-17-1-FSH2Pbu4PEDst4-45S-RS8.33-2/2/G6/150/034 | 57-02425 |

Dimension

Contacts: Power = female, Ethernet = male

RJ45

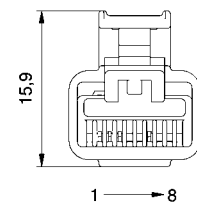
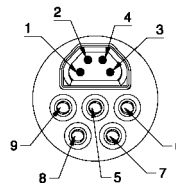
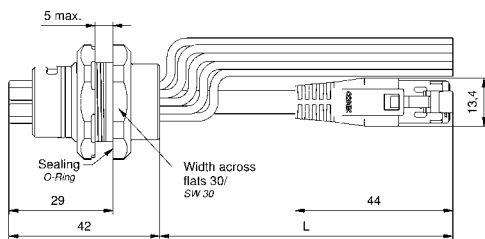

1-4: Data contacts (IEC 11801 Cat5e)
5-9: Power contacts

| Technical Data | 7-pos. (3 x 1.5 mm ² + 4x AWG22) | 7-pos. (3 x 2.5 mm ² + 4x AWG22) | 8-pos.* (4 x 1.5 mm ² + 4x AWG22) | 9-pos. (5 x 1.5 mm ² + 4x AWG22) | 7-pos. (3 x 1.5 mm ² + 4x AWG22) |
|--------------------------|---|---|--|---|---|
| Installation size | B17 | B17 | B17 | B17 | B17 |
| Coding | 1 | 1 | 1 | 1 | 1 |
| Data contacts | 4 | 4 | 4 | 4 | 4 |
| Power contacts | 2+PE | 2+PE | 3+PE | 4+PE | 2+PE |
| Locking | Bayonet | Bayonet | Bayonet | Bayonet | Bayonet |
| Current rating power | 14 A @ 30 °C | 20 A @ 30 °C | 14 A @ 30 °C | 14 A @ 30 °C | 14 A @ 30 °C |
| Current rating data | 1.5 A @ 30 °C | 1.5 A @ 30 °C | 1.5 A @ 30 °C | 1.5 A @ 30 °C | 1.5 A @ 30 °C |
| Rated voltage power | 600 AC/DC | 250 AC/DC | 600 AC/DC | 600 AC/DC | 600 AC/DC |
| Rated voltage data | 24 V DC | 24 V DC | 24 V DC | 24 V DC | 24 V DC |
| Wire cross section power | 1.5 mm ² | 2.5 mm ² | 1.5 mm ² | 1.5 mm ² | 1.5 mm ² |
| Wire cross section data | AWG22 | AWG22 | AWG22 | AWG22 | AWG22 |

*on request

B17 HYBRID RECEPTACLES
Front panel mounting, wire termination

Male connector Contacts: Power = male, Ethernet = female

TPU, UL, halogenfree, green, Cat5e + ETFE wire

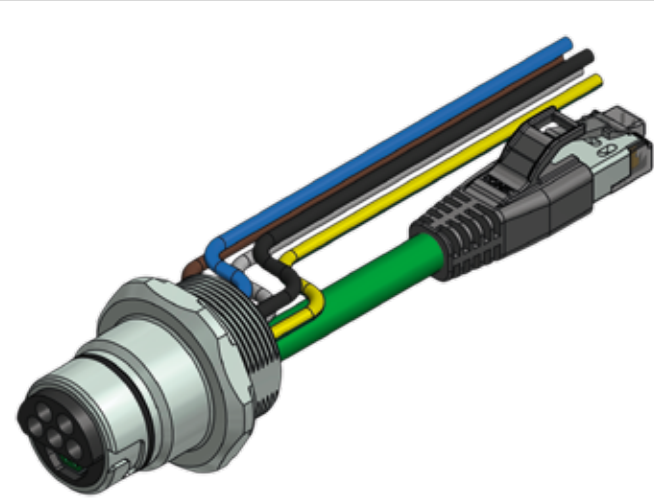

| No. of poles | Cable length = L [m] | TPU, UL, halogenfree, green, Cat5e + PVC wire | Flange housing long version, front panel mounting | Description | Part No. |
|--------------|----------------------|---|---|---|-----------|
| 3+4 | 0.5 | 1.5 | | ENP-17-1-FS1Pst2PEDbu4-45S-RS8.33-0,5/0,5/G6/150/034 | 57-02576 |
| 3+4 | 1 | 1.5 | | ENP-17-1-FS1Pst2PEDbu4-45S-RS8.33-1/1/G6/150/034 | 57-02577 |
| 3+4 | 2 | 1.5 | | ENP-17-1-FS1Pst2PEDbu4-45S-RS8.33-2/2/G6/150/034 | 57-02578 |
| 3+4 | 0.5 | 2.5 | | ENP-17-1-FS1Pst2PEADbu4-45S-RS8.33-0,5/0,5/G6/250/034 | 57-02585 |
| 3+4 | 1 | 2.5 | | ENP-17-1-FS1Pst2PEADbu4-45S-RS8.33-1/1/G6/250/034 | 57-02586 |
| 3+4 | 2 | 2.5 | | ENP-17-1-FS1Pst2PEADbu4-45S-RS8.33-2/2/G6/250/034 | 57-02587 |
| 4+4 | 0.5 | 1.5 | | ENP-17-1-FS1Pst3PEDbu4-45S-RS8.33-0,5/0,5/G6/150/034 | 57-02594* |
| 4+4 | 1 | 1.5 | | ENP-17-1-FS1Pst3PEDbu4-45S-RS8.33-1/1/G6/150/034 | 57-02595* |
| 4+4 | 2 | 1.5 | | ENP-17-1-FS1Pst3PEDbu4-45S-RS8.33-2/2/G6/150/034 | 57-02596* |
| 5+4 | 0.5 | 1.5 | | ENP-17-1-FS1Pst4PEDbu4-45S-RS8.33-0,5/0,5/G6/150/034 | 57-02603 |
| 5+4 | 1 | 1.5 | | ENP-17-1-FS1Pst4PEDbu4-45S-RS8.33-1/1/G6/150/034 | 57-02604 |
| 5+4 | 2 | 1.5 | | ENP-17-1-FS1Pst4PEDbu4-45S-RS8.33-2/2/G6/150/034 | 57-02605 |

Dimension

Contacts: Power = male, Ethernet = female

RJ45

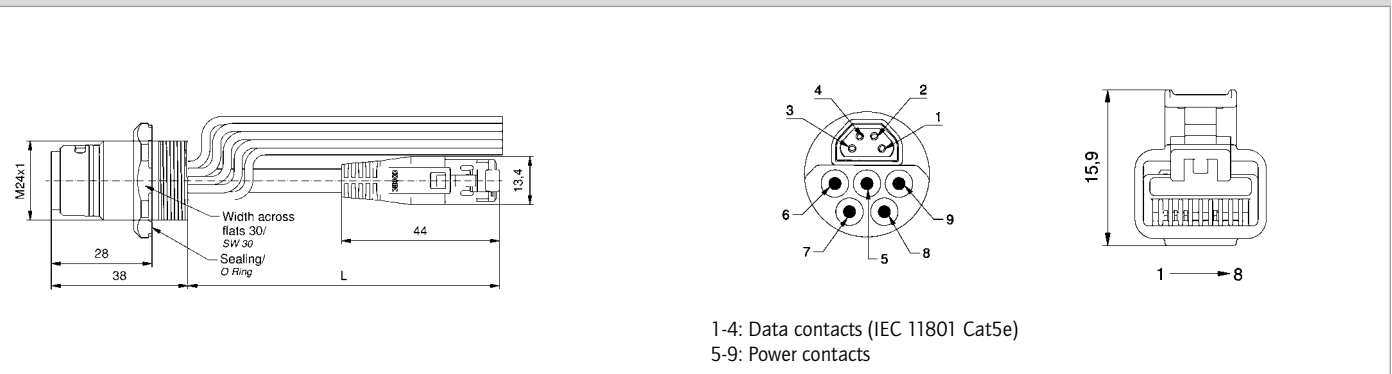

1-4: Data contacts (IEC 11801 Cat5e)
5-9: Power contacts

| Technical Data | 7-pos. (3 x 1.5 mm ² + 4 x AWG22) | 7-pos. (3 x 2.5 mm ² + 4 x AWG22) | 8-pos.* (4 x 1.5 mm ² + 4 x AWG22) | 9-pos. (5 x 1.5 mm ² + 4 x AWG22) |
|--------------------------|---|---|--|---|
| Installation size | B17 | B17 | B17 | B17 |
| Coding | 1 | 1 | 1 | 1 |
| Data contacts | 4 | 4 | 4 | 4 |
| Power contacts | 2+PE | 2+PE | 3+PE | 4+PE |
| Locking | Bayonet | Bayonet | Bayonet | Bayonet |
| Current rating power | 14 A @ 30 °C | 20 A @ 30 °C | 14 A @ 30 °C | 14 A @ 30 °C |
| Current rating data | 1.5 A @ 30 °C | 1.5 A @ 30 °C | 1.5 A @ 30 °C | 1.5 A @ 30 °C |
| Rated voltage power | 600 AC/DC | 250 AC/DC | 600 AC/DC | 600 AC/DC |
| Rated voltage data | 24 V DC | 24 V DC | 24 V DC | 24 V DC |
| Wire cross section power | 1.5 mm ² | 2.5 mm ² | 1.5 mm ² | 1.5 mm ² |
| Wire cross section data | AWG22 | AWG22 | AWG22 | AWG22 |

*on request

B17 HYBRID RECEPTACLES

Front panel mounting, wire termination

Male connector Contacts: Power = female, Ethernet = male

TPU, UL, halogenfree, green, Cat5e + ETFE wire

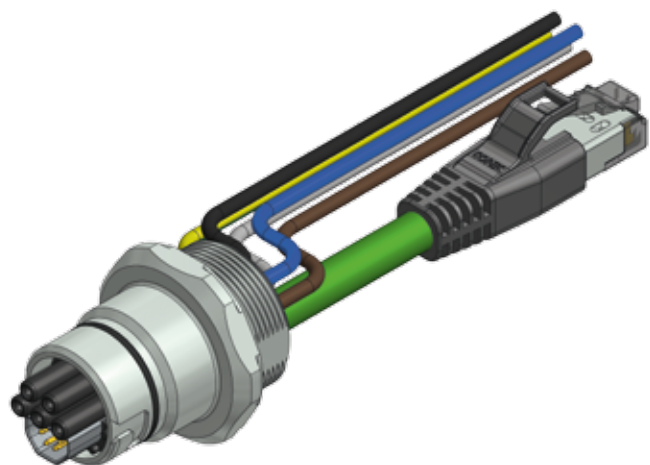

| No. of poles | Cable length = L [m] | TPU, UL, halogenfree, green, Cat5e + PVC wire | Flange housing long version, front panel mounting | |
|--------------|----------------------|---|---|-----------|
| | | | Description | Part No. |
| 3+4 | 0.5 | 1.5 | ENP-17-1-FS1Pbu2PEDst4-45S-RS8.33-0,5/0,5/G6/150/034 | 57-02612 |
| 3+4 | 1 | 1.5 | ENP-17-1-FS1Pbu2PEDst4-45S-RS8.33-1/1/G6/150/034 | 57-02613 |
| 3+4 | 2 | 1.5 | ENP-17-1-FS1Pbu2PEDst4-45S-RS8.33-2/2/G6/150/034 | 57-02614 |
| 3+4 | 0.5 | 2.5 | ENP-17-1-FS1Pbu2PEADst4-45S-RS8.33-0,5/0,5/G6/250/034 | 57-02621 |
| 3+4 | 1 | 2.5 | ENP-17-1-FS1Pbu2PEADst4-45S-RS8.33-1/1/G6/250/034 | 57-02622 |
| 3+4 | 2 | 2.5 | ENP-17-1-FS1Pbu2PEADst4-45S-RS8.33-2/2/G6/250/034 | 57-02623 |
| 4+4 | 0.5 | 1.5 | ENP-17-1-FS1Pbu3PEDst4-45S-RS8.33-0,5/0,5/G6/150/034 | 57-02630* |
| 4+4 | 1 | 1.5 | ENP-17-1-FS1Pbu3PEDst4-45S-RS8.33-1/1/G6/150/034 | 57-02631* |
| 4+4 | 2 | 1.5 | ENP-17-1-FS1Pbu3PEDst4-45S-RS8.33-2/2/G6/150/034 | 57-02632* |
| 5+4 | 0.5 | 1.5 | ENP-17-1-FS1Pbu4PEDst4-45S-RS8.33-0,5/0,5/G6/150/034 | 57-02639 |
| 5+4 | 1 | 1.5 | ENP-17-1-FS1Pbu4PEDst4-45S-RS8.33-1/1/G6/150/034 | 57-02640 |
| 5+4 | 2 | 1.5 | ENP-17-1-FS1Pbu4PEDst4-45S-RS8.33-2/2/G6/150/034 | 57-02641 |

Dimension

Contacts: Power = female, Ethernet = male

RJ45

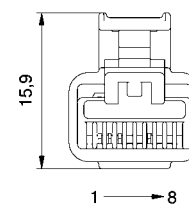
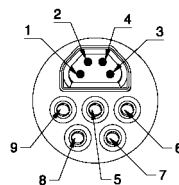
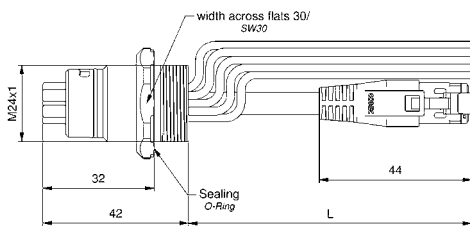

1-4: Data contacts (IEC 11801 Cat5e)
5-9: Power contacts

| Technical Data | 7-pos. (3 x 1.5 mm ² + 4 x AWG22) | 7-pos. (3 x 2.5 mm ² + 4 x AWG22) | 8-pos.* (4 x 1.5 mm ² + 4 x AWG22) | 9-pos. (5 x 1.5 mm ² + 4 x AWG22) |
|--------------------------|---|---|--|---|
| Installation size | B17 | B17 | B17 | B17 |
| Coding | 1 | 1 | 1 | 1 |
| Data contacts | 4 | 4 | 4 | 4 |
| Power contacts | 2+PE | 2+PE | 3+PE | 4+PE |
| Locking | Bayonet | Bayonet | Bayonet | Bayonet |
| Current rating power | 14 A @ 30 °C | 20 A @ 30 °C | 14 A @ 30 °C | 14 A @ 30 °C |
| Current rating data | 1.5 A @ 30 °C | 1.5 A @ 30 °C | 1.5 A @ 30 °C | 1.5 A @ 30 °C |
| Rated voltage power | 600 AC/DC | 250 AC/DC | 600 AC/DC | 600 AC/DC |
| Rated voltage data | 24 V DC | 24 V DC | 24 V DC | 24 V DC |
| Wire cross section power | 1.5 mm ² | 2.5 mm ² | 2.5 mm ² | 1.5 mm ² |
| Wire cross section data | AWG22 | AWG22 | AWG22 | AWG22 |

*on request

B17 HYBRID RECEPTACLES

Front panel mounting, wire termination

Male connector Contacts: Power = male, Ethernet = female

TPU, UL, halogenfree, green, Cat5e + ETFE wire

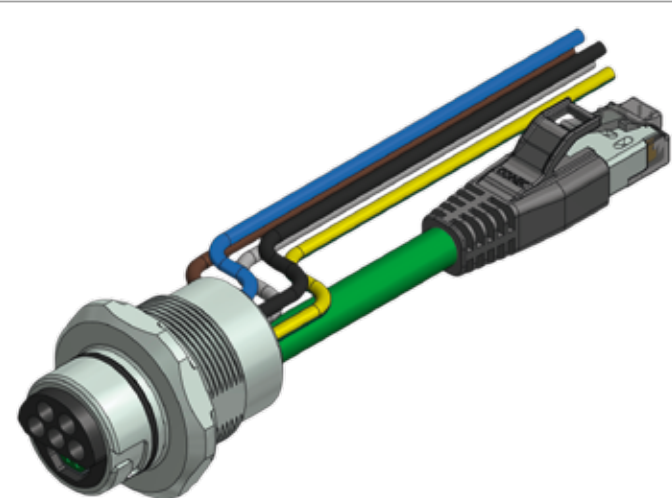

| No. of poles | Cable length = L [m] | TPU, UL, halogenfree, green, Cat5e + PVC wire | Description | Part No. |
|--------------|----------------------|---|---|-----------|
| 3+4 | 0.5 | 1.5 | ENP-17-1-FS2Pst2PEDbu4-45S-RS8.33-0,5/0,5/G6/150/034 | 57-02792 |
| 3+4 | 1 | 1.5 | ENP-17-1-FS2Pst2PEDbu4-45S-RS8.33-1/1/G6/150/034 | 57-02793 |
| 3+4 | 2 | 1.5 | ENP-17-1-FS2Pst2PEDbu4-45S-RS8.33-2/2/G6/150/034 | 57-02794 |
| 3+4 | 0.5 | 2.5 | ENP-17-1-FS2Pst2PEADbu4-45S-RS8.33-0,5/0,5/G6/250/034 | 57-02801 |
| 3+4 | 1 | 2.5 | ENP-17-1-FS2Pst2PEADbu4-45S-RS8.33-1/1/G6/250/034 | 57-02802 |
| 3+4 | 2 | 2.5 | ENP-17-1-FS2Pst2PEADbu4-45S-RS8.33-2/2/G6/250/034 | 57-02803 |
| 4+4 | 0.5 | 1.5 | ENP-17-1-FS2Pst3PEDbu4-45S-RS8.33-0,5/0,5/G6/150/034 | 57-02810* |
| 4+4 | 1 | 1.5 | ENP-17-1-FS2Pst3PEDbu4-45S-RS8.33-1/1/G6/150/034 | 57-02811* |
| 4+4 | 2 | 1.5 | ENP-17-1-FS2Pst3PEDbu4-45S-RS8.33-2/2/G6/150/034 | 57-02812* |
| 5+4 | 0.5 | 1.5 | ENP-17-1-FS2Pst4PEDbu4-45S-RS8.33-0,5/0,5/G6/150/034 | 57-02819 |
| 5+4 | 1 | 1.5 | ENP-17-1-FS2Pst4PEDbu4-45S-RS8.33-1/1/G6/150/034 | 57-02820 |
| 5+4 | 2 | 1.5 | ENP-17-1-FS2Pst4PEDbu4-45S-RS8.33-2/2/G6/150/034 | 57-02821 |

Dimension

Contacts: Power = male, Ethernet = female

RJ45

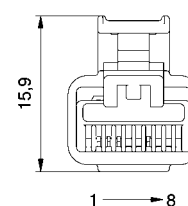
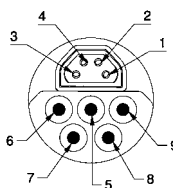
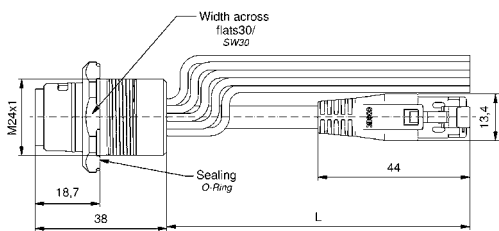

1-4: Data contacts (IEC 11801 Cat5e)
5-9: Power contacts

| Technical Data | 7-pos. (3 x 1.5 mm ² + 4 x AWG22) | 7-pos. (3 x 2.5 mm ² + 4 x AWG22) | 8-pos.* (4 x 1.5 mm ² + 4 x AWG22) | 9-pos. (5 x 1.5 mm ² + 4 x AWG22) |
|--------------------------|---|---|--|---|
| Installation size | B17 | B17 | B17 | B17 |
| Coding | 1 | 1 | 1 | 1 |
| Data contacts | 4 | 4 | 4 | 4 |
| Power contacts | 2+PE | 2+PE | 3+PE | 4+PE |
| Locking | Bayonet | Bayonet | Bayonet | Bayonet |
| Current rating power | 14 A @ 30 °C | 20 A @ 30 °C | 14 A @ 30 °C | 14 A @ 30 °C |
| Current rating data | 1.5 A @ 30 °C | 1.5 A @ 30 °C | 1.5 A @ 30 °C | 1.5 A @ 30 °C |
| Rated voltage power | 600 AC/DC | 250 AC/DC | 600 AC/DC | 600 AC/DC |
| Rated voltage data | 24 V DC | 24 V DC | 24 V DC | 24 V DC |
| Wire cross section power | 1.5 mm ² | 2.5 mm ² | 1.5 mm ² | 1.5 mm ² |
| Wire cross section data | AWG22 | AWG22 | AWG22 | AWG22 |

*on request

B17 HYBRID RECEPTACLES
Front panel mounting, wire termination

Male connector Contacts: Power = female, Ethernet = male

TPU, UL, halogenfree, green, Cat5e + ETFE wire

Flange housing short version, front panel mounting

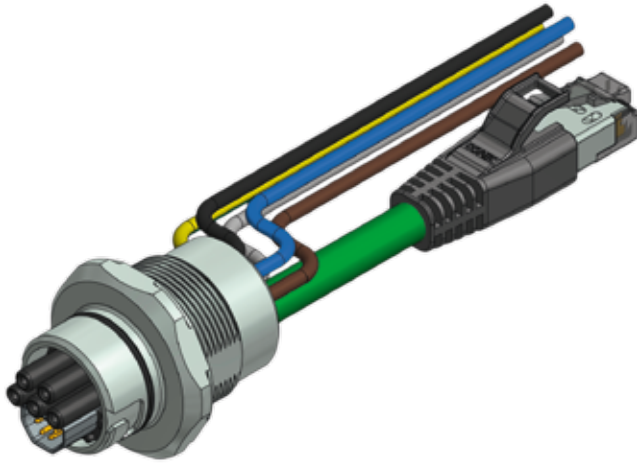

| No. of poles | Cable length = L [m] | TPU, UL, halogenfree, green, Cat5e + PVC wire | Description | Part No. |
|--------------|----------------------|---|---|-----------|
| 3+4 | 0.5 | 1.5 | ENP-17-1-FS2Pbu2PEDst4-45S-RS8.33-0,5/0,5/G6/150/034 | 57-02828 |
| 3+4 | 1 | 1.5 | ENP-17-1-FS2Pbu2PEDst4-45S-RS8.33-1/1/G6/150/034 | 57-02829 |
| 3+4 | 2 | 1.5 | ENP-17-1-FS2Pbu2PEDst4-45S-RS8.33-2/2/G6/150/034 | 57-02830 |
| 3+4 | 0.5 | 2.5 | ENP-17-1-FS2Pbu2PEADst4-45S-RS8.33-0,5/0,5/G6/250/034 | 57-02837 |
| 3+4 | 1 | 2.5 | ENP-17-1-FS2Pbu2PEADst4-45S-RS8.33-1/1/G6/250/034 | 57-02838 |
| 3+4 | 2 | 2.5 | ENP-17-1-FS2Pbu2PEADst4-45S-RS8.33-2/2/G6/250/034 | 57-02839 |
| 4+4 | 0.5 | 1.5 | ENP-17-1-FS2Pbu3PEDst4-45S-RS8.33-0,5/0,5/G6/150/034 | 57-02846* |
| 4+4 | 1 | 1.5 | ENP-17-1-FS2Pbu3PEDst4-45S-RS8.33-1/1/G6/150/034 | 57-02847* |
| 4+4 | 2 | 1.5 | ENP-17-1-FS2Pbu3PEDst4-45S-RS8.33-2/2/G6/150/034 | 57-02848* |
| 5+4 | 0.5 | 1.5 | ENP-17-1-FS2Pbu4PEDst4-45S-RS8.33-0,5/0,5/G6/150/034 | 57-02855 |
| 5+4 | 1 | 1.5 | ENP-17-1-FS2Pbu4PEDst4-45S-RS8.33-1/1/G6/150/034 | 57-02856 |
| 5+4 | 2 | 1.5 | ENP-17-1-FS2Pbu4PEDst4-45S-RS8.33-2/2/G6/150/034 | 57-02857 |

Dimension

Contacts: Power = female, Ethernet = male

RJ45

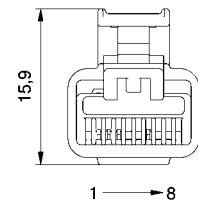
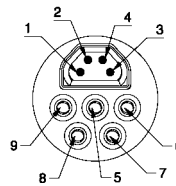
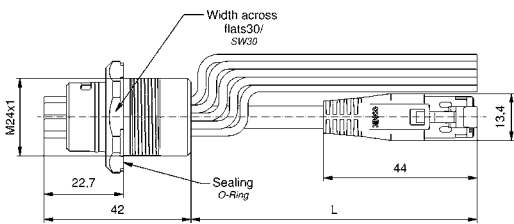

1-4: Data contacts (IEC 11801 Cat5e)
5-9: Power contacts

| Technical Data | 7-pos. (3 x 1.5 mm ² + 4 x AWG22) | 7-pos. (3 x 2.5 mm ² + 4 x AWG22) | 8-pos.* (4 x 1.5 mm ² + 4 x AWG22) | 9-pos. (5 x 1.5 mm ² + 4 x AWG22) |
|--------------------------|---|---|--|---|
| Installation size | B17 | B17 | B17 | B17 |
| Coding | 1 | 1 | 1 | 1 |
| Data contacts | 4 | 4 | 4 | 4 |
| Power contacts | 2+PE | 2+PE | 3+PE | 4+PE |
| Locking | Bayonet | Bayonet | Bayonet | Bayonet |
| Current rating power | 14 A @ 30 °C | 20 A @ 30 °C | 14 A @ 30 °C | 14 A @ 30 °C |
| Current rating data | 1.5 A @ 30 °C | 1.5 A @ 30 °C | 1.5 A @ 30 °C | 1.5 A @ 30 °C |
| Rated voltage power | 600 AC/DC | 250 AC/DC | 600 AC/DC | 600 AC/DC |
| Rated voltage data | 24 V DC | 24 V DC | 24 V DC | 24 V DC |
| Wire cross section power | 1.5 mm ² | 2.5 mm ² | 1.5 mm ² | 1.5 mm ² |
| Wire cross section data | AWG22 | AWG22 | AWG22 | AWG22 |

*on request

B17 HYBRID RECEPTACLES

Front panel mounting, wire termination

Male connector Contacts: Power = male, Ethernet = female

TPU, UL, halogenfree, green, Cat5e + ETFE wire

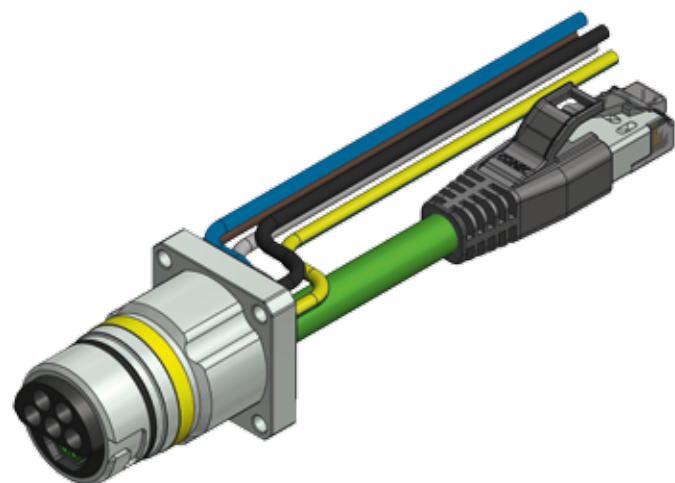

| No. of poles | Cable length = L [m] | TPU, UL, halogenfree, green, Cat5e + PVC wire | Description | Part No. |
|--------------|----------------------|---|--|-----------|
| 3+4 | 0.5 | 1.5 | ENP-17-1-FSV1Pst2PEDbu4-45S-RS8.33-0,5/0,5/G6/150/034 | 57-03008 |
| 3+4 | 1 | 1.5 | ENP-17-1-FSV1Pst2PEDbu4-45S-RS8.33-1/1/G6/150/034 | 57-03009 |
| 3+4 | 2 | 1.5 | ENP-17-1-FSV1Pst2PEDbu4-45S-RS8.33-2/2/G6/150/034 | 57-03010 |
| 3+4 | 0.5 | 2.5 | ENP-17-1-FSV1Pst2PEADbu4-45S-RS8.33-0,5/0,5/G6/250/034 | 57-03017 |
| 3+4 | 1 | 2.5 | ENP-17-1-FSV1Pst2PEADbu4-45S-RS8.33-1/1/G6/250/034 | 57-03018 |
| 3+4 | 2 | 2.5 | ENP-17-1-FSV1Pst2PEADbu4-45S-RS8.33-2/2/G6/250/034 | 57-03019 |
| 4+4 | 0.5 | 1.5 | ENP-17-1-FSV1Pst3PEDbu4-45S-RS8.33-0,5/0,5/G6/150/034 | 57-03026* |
| 4+4 | 1 | 1.5 | ENP-17-1-FSV1Pst3PEDbu4-45S-RS8.33-1/1/G6/150/034 | 57-03027* |
| 4+4 | 2 | 1.5 | ENP-17-1-FSV1Pst3PEDbu4-45S-RS8.33-2/2/G6/150/034 | 57-03028* |
| 5+4 | 0.5 | 1.5 | ENP-17-1-FSV1Pst4PEDbu4-45S-RS8.33-0,5/0,5/G6/150/034 | 57-03035 |
| 5+4 | 1 | 1.5 | ENP-17-1-FSV1Pst4PEDbu4-45S-RS8.33-1/1/G6/150/034 | 57-03036 |
| 5+4 | 2 | 1.5 | ENP-17-1-FSV1Pst4PEDbu4-45S-RS8.33-2/2/G6/150/034 | 57-03037 |

Dimension

Contacts: Power = male, Ethernet = female

RJ45

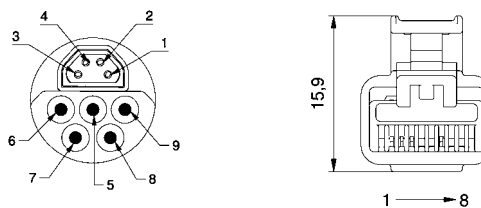
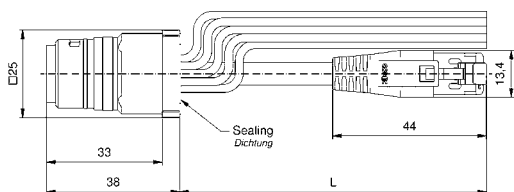

1-4: Data contacts (IEC 11801 Cat5e)
5-9: Power contacts

| Technical Data | 7-pos. (3 x 1.5 mm ² + 4 x AWG22) | 7-pos. (3 x 2.5 mm ² + 4 x AWG22) | 8-pos.* (4 x 1.5 mm ² + 4 x AWG22) | 9-pos. (5 x 1.5 mm ² + 4 x AWG22) |
|--------------------------|---|---|--|---|
| Installation size | B17 | B17 | B17 | B17 |
| Coding | 1 | 1 | 1 | 1 |
| Data contacts | 4 | 4 | 4 | 4 |
| Power contacts | 2+PE | 2+PE | 3+PE | 4+PE |
| Locking | Bayonet | Bayonet | Bayonet | Bayonet |
| Current rating power | 14 A @ 30 °C | 20 A @ 30 °C | 14 A @ 30 °C | 14 A @ 30 °C |
| Current rating data | 1.5 A @ 30 °C | 1.5 A @ 30 °C | 1.5 A @ 30 °C | 1.5 A @ 30 °C |
| Rated voltage power | 600 AC/DC | 250 AC/DC | 600 AC/DC | 600 AC/DC |
| Rated voltage data | 24 V DC | 24 V DC | 24 V DC | 24 V DC |
| Wire cross section power | 1.5 mm ² | 2.5 mm ² | 1.5 mm ² | 1.5 mm ² |
| Wire cross section data | AWG22 | AWG22 | AWG22 | AWG22 |

*on request

B17 HYBRID RECEPTACLES
Front panel mounting, wire termination

Male connector Contacts: Power = female, Ethernet = male

TPU, UL, halogenfree, green, Cat5e + ETFE wire

Flange housing long version square, front panel mounting, 4-hole drill pattern 19.8 mm

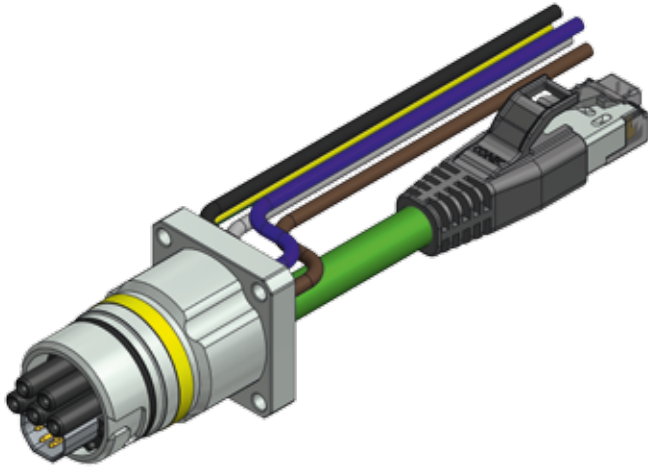

| No. of poles | Cable length = L [m] | TPU, UL, halogenfree, green, Cat5e + PVC wire | Description | Part No. |
|--------------|----------------------|---|--|-----------|
| 3+4 | 0.5 | 1.5 | ENP-17-1-FSV1Pbu2PEDst4-45S-RS8.33-0,5/0,5/G6/150/034 | 57-03044 |
| 3+4 | 1 | 1.5 | ENP-17-1-FSV1Pbu2PEDst4-45S-RS8.33-1/1/G6/150/034 | 57-03045 |
| 3+4 | 2 | 1.5 | ENP-17-1-FSV1Pbu2PEDst4-45S-RS8.33-2/2/G6/150/034 | 57-03046 |
| 3+4 | 0.5 | 2.5 | ENP-17-1-FSV1Pbu2PEADst4-45S-RS8.33-0,5/0,5/G6/250/034 | 57-03053 |
| 3+4 | 1 | 2.5 | ENP-17-1-FSV1Pbu2PEADst4-45S-RS8.33-1/1/G6/250/034 | 57-03054 |
| 3+4 | 2 | 2.5 | ENP-17-1-FSV1Pbu2PEADst4-45S-RS8.33-2/2/G6/250/034 | 57-03055 |
| 4+4 | 0.5 | 1.5 | ENP-17-1-FSV1Pbu3PEDst4-45S-RS8.33-0,5/0,5/G6/150/034 | 57-03062* |
| 4+4 | 1 | 1.5 | ENP-17-1-FSV1Pbu3PEDst4-45S-RS8.33-1/1/G6/150/034 | 57-03063* |
| 4+4 | 2 | 1.5 | ENP-17-1-FSV1Pbu3PEDst4-45S-RS8.33-2/2/G6/150/034 | 57-03064* |
| 5+4 | 0.5 | 1.5 | ENP-17-1-FSV1Pbu4PEDst4-45S-RS8.33-0,5/0,5/G6/150/034 | 57-03071 |
| 5+4 | 1 | 1.5 | ENP-17-1-FSV1Pbu4PEDst4-45S-RS8.33-1/1/G6/150/034 | 57-03072 |
| 5+4 | 2 | 1.5 | ENP-17-1-FSV1Pbu4PEDst4-45S-RS8.33-2/2/G6/150/034 | 57-03073 |

Dimension

Contacts: Power = female, Ethernet = male

RJ45

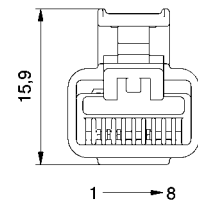
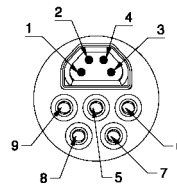
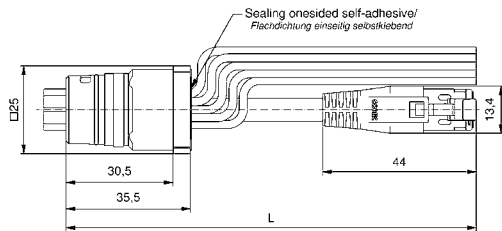

1-4: Data contacts (IEC 11801 Cat5e)
5-9: Power contacts

| Technical Data | 7-pos. (3 x 1.5 mm ² + 4 x AWG22) | 7-pos. (3 x 2.5 mm ² + 4 x AWG22) | 8-pos.* (4 x 1.5 mm ² + 4 x AWG22) | 9-pos. (5 x 1.5 mm ² + 4 x AWG22) |
|--------------------------|---|---|--|---|
| Installation size | B17 | B17 | B17 | B17 |
| Coding | 1 | 1 | 1 | 1 |
| Data contacts | 4 | 4 | 4 | 4 |
| Power contacts | 2+PE | 2+PE | 3+PE | 4+PE |
| Locking | Bayonet | Bayonet | Bayonet | Bayonet |
| Current rating power | 14 A @ 30 °C | 20 A @ 30 °C | 14 A @ 30 °C | 14 A @ 30 °C |
| Current rating data | 1.5 A @ 30 °C | 1.5 A @ 30 °C | 1.5 A @ 30 °C | 1.5 A @ 30 °C |
| Rated voltage power | 600 AC/DC | 250 AC/DC | 600 AC/DC | 600 AC/DC |
| Rated voltage data | 24 V DC | 24 V DC | 24 V DC | 24 V DC |
| Wire cross section power | 1.5 mm ² | 2.5 mm ² | 1.5 mm ² | 1.5 mm ² |
| Wire cross section data | AWG22 | AWG22 | AWG22 | AWG22 |

*on request

B17 HYBRID RECEPTACLES

Front panel mounting, wire termination

Male connector Contacts: Power = male, Ethernet = female

TPU, UL, halogenfree, green, Cat5e + ETFE wire

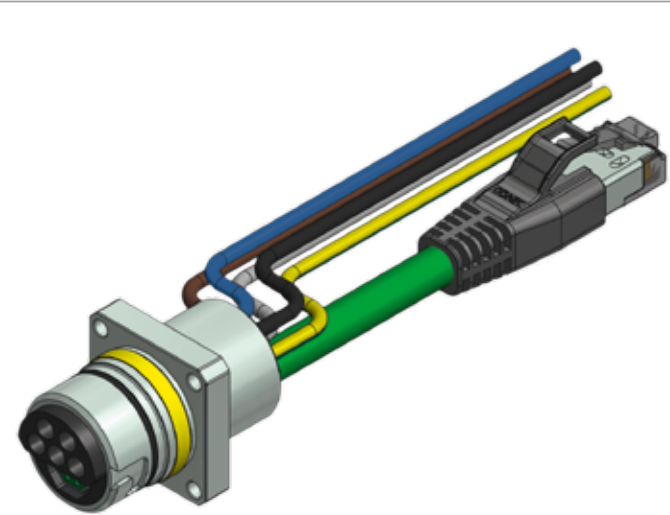

| No. of poles | Cable length = L [m] | TPU, UL, halogenfree, green, Cat5e + PVC wire | Description | Part No. |
|--------------|----------------------|---|--|-----------|
| 3+4 | 0.5 | 1.5 | ENP-17-1-FSV2Pst2PEDbu4-45S-RS8.33-0,5/0,5/G6/150/034 | 57-03224 |
| 3+4 | 1 | 1.5 | ENP-17-1-FSV2Pst2PEDbu4-45S-RS8.33-1/1/G6/150/034 | 57-03225 |
| 3+4 | 2 | 1.5 | ENP-17-1-FSV2Pst2PEDbu4-45S-RS8.33-2/2/G6/150/034 | 57-03226 |
| 3+4 | 0.5 | 2.5 | ENP-17-1-FSV2Pst2PEADbu4-45S-RS8.33-0,5/0,5/G6/250/034 | 57-03233 |
| 3+4 | 1 | 2.5 | ENP-17-1-FSV2Pst2PEADbu4-45S-RS8.33-1/1/G6/250/034 | 57-03234 |
| 3+4 | 2 | 2.5 | ENP-17-1-FSV2Pst2PEADbu4-45S-RS8.33-2/2/G6/250/034 | 57-03235 |
| 4+4 | 0.5 | 1.5 | ENP-17-1-FSV2Pst3PEDbu4-45S-RS8.33-0,5/0,5/G6/150/034 | 57-03242* |
| 4+4 | 1 | 1.5 | ENP-17-1-FSV2Pst3PEDbu4-45S-RS8.33-1/1/G6/150/034 | 57-03243* |
| 4+4 | 2 | 1.5 | ENP-17-1-FSV2Pst3PEDbu4-45S-RS8.33-2/2/G6/150/034 | 57-03244* |
| 5+4 | 0.5 | 1.5 | ENP-17-1-FSV2Pst4PEDbu4-45S-RS8.33-0,5/0,5/G6/150/034 | 57-03251 |
| 5+4 | 1 | 1.5 | ENP-17-1-FSV2Pst4PEDbu4-45S-RS8.33-1/1/G6/150/034 | 57-03252 |
| 5+4 | 2 | 1.5 | ENP-17-1-FSV2Pst4PEDbu4-45S-RS8.33-2/2/G6/150/034 | 57-03253 |

Flange housing short version square, front panel mounting, 4-hole drill pattern 19,8 mm

Dimension

Contacts: Power = male, Ethernet = female

RJ45

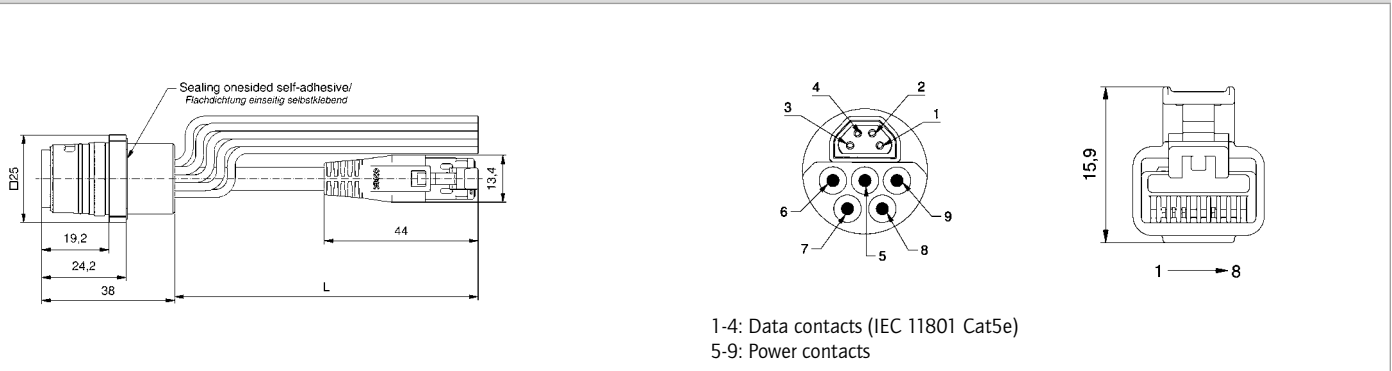

| Technical Data | 7-pos. (3 x 1.5 mm ² + 4 x AWG22) | 7-pos. (3 x 2.5 mm ² + 4 x AWG22) | 8-pos.* (4 x 1.5 mm ² + 4 x AWG22) | 9-pos. (5 x 1.5 mm ² + 4 x AWG22) |
|--------------------------|---|---|--|---|
| Installation size | B17 | B17 | B17 | B17 |
| Coding | 1 | 1 | 1 | 1 |
| Data contacts | 4 | 4 | 4 | 4 |
| Power contacts | 2+PE | 2+PE | 3+PE | 4+PE |
| Locking | Bayonet | Bayonet | Bayonet | Bayonet |
| Current rating power | 14 A @ 30 °C | 20 A @ 30 °C | 14 A @ 30 °C | 14 A @ 30 °C |
| Rated voltage power | 600 AC/DC | 250 AC/DC | 600 AC/DC | 600 AC/DC |
| Current rating data | 1.5 A @ 30 °C | 1.5 A @ 30 °C | 1.5 A @ 30 °C | 1.5 A @ 30 °C |
| Rated voltage data | 24 V DC | 24 V DC | 24 V DC | 24 V DC |
| Wire cross section power | 1.5 mm ² | 2.5 mm ² | 1.5 mm ² | 1.5 mm ² |
| Wire cross section data | AWG22 | AWG22 | AWG22 | AWG22 |

*on request

B17 HYBRID RECEPTACLES
Front panel mounting, wire termination

Male connector Contacts: Power = female, Ethernet = male

TPU, UL, halogenfree, green, Cat5e + ETFE wire

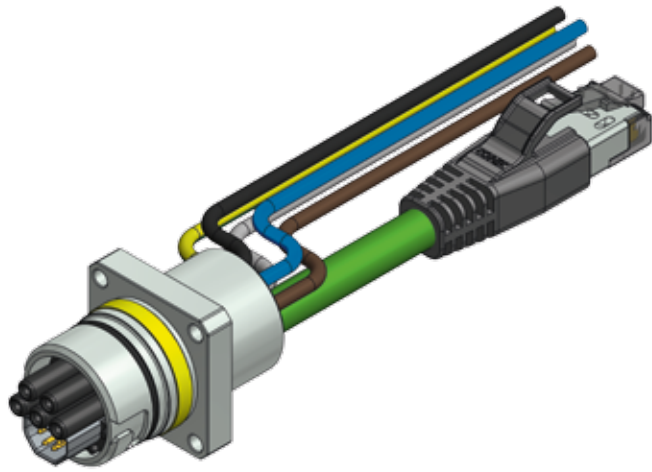

Flange housing short version square, front panel mounting, 4-hole drill pattern 19.8 mm

| No. of poles | Cable length = L [m] | TPU, UL, halogenfree, green, Cat5e + PVC wire | Description | Part No. |
|--------------|----------------------|---|--|-----------|
| 3+4 | 0.5 | 1.5 | ENP-17-1-FSV2Pbu2PEDst4-45S-RS8.33-0,5/0,5/G6/150/034 | 57-03260 |
| 3+4 | 1 | 1.5 | ENP-17-1-FSV2Pbu2PEDst4-45S-RS8.33-1/1/G6/150/034 | 57-03261 |
| 3+4 | 2 | 1.5 | ENP-17-1-FSV2Pbu2PEDst4-45S-RS8.33-2/2/G6/150/034 | 57-03262 |
| 3+4 | 0.5 | 2.5 | ENP-17-1-FSV2Pbu2PEADst4-45S-RS8.33-0,5/0,5/G6/250/034 | 57-03269 |
| 3+4 | 1 | 2.5 | ENP-17-1-FSV2Pbu2PEADst4-45S-RS8.33-1/1/G6/250/034 | 57-03270 |
| 3+4 | 2 | 2.5 | ENP-17-1-FSV2Pbu2PEADst4-45S-RS8.33-2/2/G6/250/034 | 57-03271 |
| 4+4 | 0.5 | 1.5 | ENP-17-1-FSV2Pbu3PEDst4-45S-RS8.33-0,5/0,5/G6/150/034 | 57-03278* |
| 4+4 | 1 | 1.5 | ENP-17-1-FSV2Pbu3PEDst4-45S-RS8.33-1/1/G6/150/034 | 57-03279* |
| 4+4 | 2 | 1.5 | ENP-17-1-FSV2Pbu3PEDst4-45S-RS8.33-2/2/G6/150/034 | 57-03280* |
| 5+4 | 0.5 | 1.5 | ENP-17-1-FSV2Pbu4PEDst4-45S-RS8.33-0,5/0,5/G6/150/034 | 57-03287 |
| 5+4 | 1 | 1.5 | ENP-17-1-FSV2Pbu4PEDst4-45S-RS8.33-1/1/G6/150/034 | 57-03288 |
| 5+4 | 2 | 1.5 | ENP-17-1-FSV2Pbu4PEDst4-45S-RS8.33-2/2/G6/150/034 | 57-03289 |

Dimension

Contacts: Power = female, Ethernet = male

RJ45

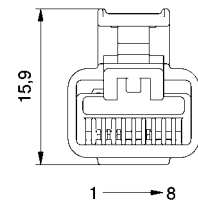
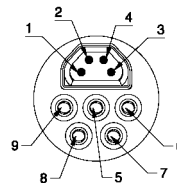
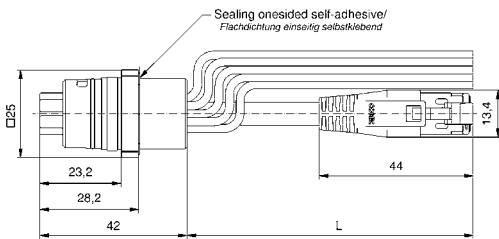

1-4: Data contacts (IEC 11801 Cat5e)
5-9: Power contacts

| Technical Data | 7-pos. (3 x 1.5 mm ² + 4 x AWG22) | 7-pos. (3 x 2.5 mm ² + 4 x AWG22) | 8-pos.* (4 x 1.5 mm ² + 4 x AWG22) | 9-pos. (5 x 1.5 mm ² + 4 x AWG22) |
|--------------------------|---|---|--|---|
| Installation size | B17 | B17 | B17 | B17 |
| Coding | 1 | 1 | 1 | 1 |
| Data contacts | 4 | 4 | 4 | 4 |
| Power contacts | 2+PE | 2+PE | 3+PE | 4+PE |
| Locking | Bayonet | Bayonet | Bayonet | Bayonet |
| Current rating power | 14 A @ 30 °C | 20 A @ 30 °C | 14 A @ 30 °C | 14 A @ 30 °C |
| Current rating data | 1.5 A @ 30 °C | 1.5 A @ 30 °C | 1.5 A @ 30 °C | 1.5 A @ 30 °C |
| Rated voltage power | 600 AC/DC | 250 AC/DC | 600 AC/DC | 600 AC/DC |
| Rated voltage data | 24 V DC | 24 V DC | 24 V DC | 24 V DC |
| Wire cross section power | 1.5 mm ² | 2.5 mm ² | 1.5 mm ² | 1.5 mm ² |
| Wire cross section data | AWG22 | AWG22 | AWG22 | AWG22 |

*on request

B23 HYBRID CONNECTORS

Preview

Overview



Characteristics

- Separately shielded data element for Industrial Ethernet connections according to IE C11801 Cat5e, as known from the SuperCon sizes B12 and B17
- Available as overmoulded and field attachable version and receptacles with a different number of housings
- All versions available with a wire cross section of 4 mm² (version 4+PE), thus perfectly suitable for applications with high power consumption
- Bayonet fast locking for quick and secure connections

| Characteristics | Connector overmoulded | Connector field attachable | Receptacles |
|---|-----------------------|--|---------------|
| Coding | 1, 2, 3 | 1, 2, 3 | 1, 2, 3 |
| Female | ✓ | ✓ | |
| Male | | | ✓ |
| Shielding | ✓ | ✓ | ✓ |
| No. of poles data transmission | | 4 | |
| No. of poles power | | 4-PE, 2 + 3+PE | |
| Current rating power | | 32 A @ 30 °C (4+PE) 32 A + 20 A @ 30 °C (2+ 3+PE) | |
| Current rating data | 3 A @ 30 °C | 3 A @ 30 °C | 1.5 A @ 30 °C |
| Rated voltage power | | 600 V | |
| Rated voltage data | | 24 V DC | |
| Cable quality | | TPU | |
| Bayonet locking | ✓ | ✓ | ✓ |
| Degree of protection (in mated condition) | | IP67 | |

ACCESSORIES





ACCESSORIES

Tools

| Hand crimp tool | Suitable contacts | Part No. |
|---|--|-----------|
|  | Suitable for: M8 P-coding field-attachable Data contacts B12/B17/B23 Power contacts B12/B17 | 36-000640 |
| Insert for hand crimp tool | Suitable contacts | Part No. |
|  | Suitable for: M8 P-coding field-attachable Data contacts B12/B17/B23 Power contacts B12/B17 | 36-000610 |

ACCESSORIES

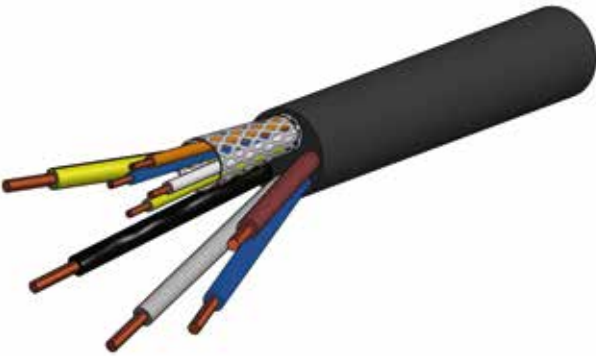

Hybrid cables

GAZ= Hybrid cable, halogenfree, for drag chain applications

| | Wire cross section power | Wire cross section data | Number of wires power | Number of wires data | Color cable jacket | Wire colors power | Wire colors data | Datasheet No. |
|---|--------------------------|-------------------------|-----------------------|----------------------|--------------------|---|----------------------------|---------------|
|  | 0.75 mm ² | AWG22 | 2 | 4 | black | RD - BU - OR - BU | WT - YE - OR - BU | 781-GAZ010H |
| | 1.5 mm ² | AWG22 | 3 | 4 | black | BN - BU - GN/ YE | WT - YE - OR - BU | 781-GAZ011H |
| | 2.5 mm ² | AWG22 | 3 | 4 | black | BN - BU - GN/ YE | WT - YE - OR - BU | 781-GAZ012H |
| | 1.5 mm ² | AWG22 | 4 | 4 | black | BN - BK - GY - GN/ YE | WT - YE - OR - BU | 781-GAZ013H |
| | 1.5 mm ² | AWG22 | 5 | 4 | black | BN - BU - GY - BK - GN/ YE | WT - YE - OR - BU | 781-GAZ014H |

ACCESSORIES

Color coding

| Connectors overmoulded/Panel mount connectors male, square housing | Size | Color | Part No. |
|---|------|--------|----------|
|  | B12 | yellow | 56-99000 |
| | B12 | green | 56-99001 |
| | B17 | yellow | 57-99000 |
| | B17 | green | 57-99001 |
| | B17 | orange | 57-99002 |
| Connectors field attachable | | | |
|  | B12 | yellow | 56-99002 |
| | B12 | green | 56-99003 |
| | B17 | yellow | 57-99003 |
| | B17 | green | 57-99004 |
| | B17 | orange | 57-99005 |
| Panel mount connector male, front- and back panel mounting | | | |
|  | B12 | yellow | 56-99004 |
| | B12 | green | 56-99005 |
| | B17 | yellow | 57-99006 |
| | B17 | green | 57-99007 |
| | B17 | orange | 57-99008 |

ACCESSORIES

Protection caps

Receptacle male

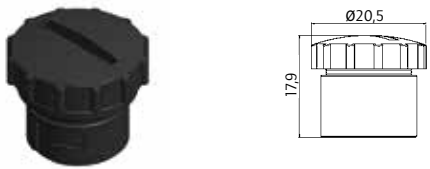
| | Size B12 | Size B17 | Material protection cap | Degree of protection | Color | Part No. |
|---|----------|----------|-------------------------|----------------------|-------|----------|
|  | ✓ | | PA | IP67 | black | 56-99006 |
| | | ✓ | PA | IP67 | black | 57-99010 |
| Female connector (overmoulded, field attachable) | | | | | | |
|  | ✓ | | PA | IP67 | black | 56-99008 |
| | | ✓ | PA | IP67 | black | 57-99012 |

ACCESSORIES

Hex nut

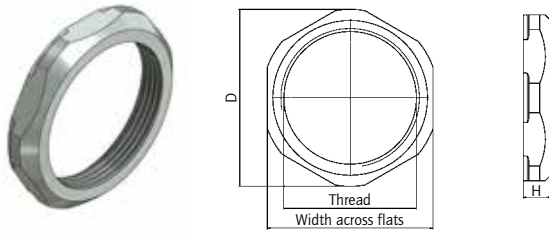
| | Size B12 | Size B17 | Thread | Width across flats | Outer $\varnothing = D$ [mm] | Height = H [mm] | Material | Description | Part No. |
|---|----------|----------|--------|--------------------|------------------------------|-----------------|----------|-------------|----------|
|  | ✓ | | M18x1 | SW24 | 26 | 5 | CuZn, Ni | | 56-99010 |
| | | ✓ | M24x1 | SW30 | 32 | 5 | CuZn, Ni | | 57-99014 |

PART NUMBER INDEX

Numeric

| Part number | Page | Part number | Page | Part number | Page | Part number | Page |
|-------------|------|-------------|------|-------------|------|-------------|------|
| 36-000610 | 46 | 57-00024 | 30 | 57-02604 | 35 | 57-03071 | 40 |
| 36-000640 | 46 | 57-02144 | 31 | 57-02605 | 35 | 57-03072 | 40 |
| 56-00009 | 15 | 57-02145 | 31 | 57-02612 | 36 | 57-03073 | 40 |
| 56-00011 | 15 | 57-02146 | 31 | 57-02613 | 36 | 57-03224 | 41 |
| 56-02024 | 16 | 57-02153 | 31 | 57-02614 | 36 | 57-03225 | 41 |
| 56-02025 | 16 | 57-02154 | 31 | 57-02621 | 36 | 57-03226 | 41 |
| 56-02026 | 16 | 57-02155 | 31 | 57-02622 | 36 | 57-03233 | 41 |
| 56-02030 | 17 | 57-02162 | 31 | 57-02623 | 36 | 57-03234 | 41 |
| 56-02031 | 17 | 57-02163 | 31 | 57-02630 | 36 | 57-03235 | 41 |
| 56-02032 | 17 | 57-02164 | 31 | 57-02631 | 36 | 57-03242 | 41 |
| 56-02060 | 18 | 57-02171 | 31 | 57-02632 | 36 | 57-03243 | 41 |
| 56-02061 | 18 | 57-02172 | 31 | 57-02639 | 36 | 57-03244 | 41 |
| 56-02062 | 18 | 57-02173 | 31 | 57-02640 | 36 | 57-03251 | 41 |
| 56-02066 | 19 | 57-02180 | 32 | 57-02641 | 36 | 57-03252 | 41 |
| 56-02067 | 19 | 57-02181 | 32 | 57-02792 | 37 | 57-03253 | 41 |
| 56-02068 | 19 | 57-02182 | 32 | 57-02793 | 37 | 57-03260 | 42 |
| 56-02096 | 20 | 57-02189 | 32 | 57-02794 | 37 | 57-03261 | 42 |
| 56-02097 | 20 | 57-02190 | 32 | 57-02801 | 37 | 57-03262 | 42 |
| 56-02098 | 20 | 57-02191 | 32 | 57-02802 | 37 | 57-03269 | 42 |
| 56-02102 | 21 | 57-02198 | 32 | 57-02803 | 37 | 57-03270 | 42 |
| 56-02103 | 21 | 57-02199 | 32 | 57-02810 | 37 | 57-03271 | 42 |
| 56-02104 | 21 | 57-02200 | 32 | 57-02811 | 37 | 57-03278 | 42 |
| 56-02132 | 22 | 57-02207 | 32 | 57-02812 | 37 | 57-03279 | 42 |
| 56-02133 | 22 | 57-02208 | 32 | 57-02819 | 37 | 57-03280 | 42 |
| 56-02134 | 22 | 57-02209 | 32 | 57-02820 | 37 | 57-03287 | 42 |
| 56-02138 | 23 | 57-02360 | 33 | 57-02821 | 37 | 57-03288 | 42 |
| 56-02139 | 23 | 57-02361 | 33 | 57-02828 | 38 | 57-03289 | 42 |
| 56-02140 | 23 | 57-02362 | 33 | 57-02829 | 38 | 57-07644 | 28 |
| 56-02168 | 24 | 57-02369 | 33 | 57-02830 | 38 | 57-07645 | 28 |
| 56-02169 | 24 | 57-02370 | 33 | 57-02837 | 38 | 57-07646 | 28 |
| 56-02170 | 24 | 57-02371 | 33 | 57-02838 | 38 | 57-07653 | 28 |
| 56-02174 | 25 | 57-02378 | 33 | 57-02839 | 38 | 57-07654 | 28 |
| 56-02175 | 25 | 57-02379 | 33 | 57-02846 | 38 | 57-07655 | 28 |
| 56-02176 | 25 | 57-02380 | 33 | 57-02847 | 38 | 57-07662 | 28 |
| 56-02204 | 26 | 57-02387 | 33 | 57-02848 | 38 | 57-07663 | 28 |
| 56-02205 | 26 | 57-02388 | 33 | 57-02855 | 38 | 57-07664 | 28 |
| 56-02206 | 26 | 57-02389 | 33 | 57-02856 | 38 | 57-07671 | 28 |
| 56-02210 | 27 | 57-02396 | 34 | 57-02857 | 38 | 57-07672 | 28 |
| 56-02211 | 27 | 57-02397 | 34 | 57-03008 | 39 | 57-07673 | 28 |
| 56-02212 | 27 | 57-02398 | 34 | 57-03009 | 39 | 57-99000 | 47 |
| 56-07524 | 14 | 57-02405 | 34 | 57-03010 | 39 | 57-99001 | 47 |
| 56-07525 | 14 | 57-02406 | 34 | 57-03017 | 39 | 57-99002 | 47 |
| 56-07526 | 14 | 57-02407 | 34 | 57-03018 | 39 | 57-99003 | 47 |
| 56-99000 | 47 | 57-02414 | 34 | 57-03019 | 39 | 57-99004 | 47 |
| 56-99001 | 47 | 57-02415 | 34 | 57-03026 | 39 | 57-99005 | 47 |
| 56-99002 | 47 | 57-02416 | 34 | 57-03027 | 39 | 57-99006 | 47 |
| 56-99003 | 47 | 57-02423 | 34 | 57-03028 | 39 | 57-99007 | 47 |
| 56-99004 | 47 | 57-02424 | 34 | 57-03035 | 39 | 57-99008 | 47 |
| 56-99005 | 47 | 57-02425 | 34 | 57-03036 | 39 | 57-99010 | 48 |
| 56-99006 | 48 | 57-02576 | 35 | 57-03037 | 39 | 57-99012 | 48 |
| 56-99008 | 48 | 57-02577 | 35 | 57-03044 | 40 | 57-99014 | 48 |
| 56-99010 | 48 | 57-02578 | 35 | 57-03045 | 40 | 781-GAZ010H | 46 |
| 57-00017 | 29 | 57-02585 | 35 | 57-03046 | 40 | 781-GAZ011H | 46 |
| 57-00018 | 29 | 57-02586 | 35 | 57-03053 | 40 | 781-GAZ012H | 46 |
| 57-00019 | 29 | 57-02587 | 35 | 57-03054 | 40 | 781-GAZ013H | 46 |
| 57-00020 | 29 | 57-02594 | 35 | 57-03055 | 40 | 781-GAZ014H | 46 |
| 57-00021 | 30 | 57-02595 | 35 | 57-03062 | 40 | | |
| 57-00022 | 30 | 57-02596 | 35 | 57-03063 | 40 | | |
| 57-00023 | 30 | 57-02603 | 35 | 57-03064 | 40 | | |

ADDITIONAL PRODUCT CATEGORIES _____





ADDITIONAL CONEC PRODUCT CATEGORIES

Circular connectors overmoulded



Details

- Size: M8x1, M12x1, 7/8", Rund24
- Coding: A, B, C, D, L, P, S, T, X
- Number of poles: 3, 4, 5, 6, 8, 12, 2+PE, 3+PE, 4+FE, 4+PE, 6+PE
- Configuration: axial or angled, shielded or unshielded
- Optional with LED
- Termination: screw-, snap-, screw-/snap-termination
- Degree of protection: IP67

Benefits

- Robust design with minimum space requirements
- Mating can be controlled with torque wrench
- Vibration proof screw lock
- Application-related cable qualities

Circular connectors field attachable



Details

- Size: M8x1, M12x1, 7/8", Rund24
- Coding: A, B, D, P, X
- Number of poles: 3, 4, 5, 8, 2+PE, 3+PE, 4+PE, 6+PE
- Configuration: axial or angled, shielded or unshielded
- Termination: solder-, clamp-, screw-, crimp termination
- Degree of protection: IP67

Benefits

- Mating can be controlled with torque wrench (M8, M12)
- Easy field attachable without special tools
- M12x1 cable cross section 1.5 mm²
- Vibration proof screw lock

ADDITIONAL CONEC PRODUCT CATEGORIES

Sockets



Details

- Size: M8x1, M12x1, 7/8"
- Coding: A, B, D, L, P, S, T, X
- Number of poles: 3, 4, 5, 6, 8, 12, 2+PE, 3+PE, 4+FE, 4+PE
- Male socket, female socket
- Configuration: axial or angled
- Degree of protection: IP67
- Field attachable crimp version
- Assembly: Protection cap

Benefits

- Front and back panel mounting
- Colored contact insulators to avoid wrong plugging
- High number of poles with minimum space requirements
- Direct circuit board mounting
- Protection of unused interfaces

Sockets SMT/THR



Details

- Size: M8x1 SMT/THR, M12x1 SMT
- Coding: A, B, D, X
- Number of poles: 3, 4, 5, 8
- Male socket, female socket
- Configuration: axial or angled, shielded or unshielded
- Degree of protection: IP67

Benefits

- Front and back panel mounting
- Automated assembly (SMT)
- High number of poles with minimum space requirements
- Low forces on the board
- Low contact resistance on the shielding
- Large tolerance compensation between board and housing

ADDITIONAL CONEC PRODUCT CATEGORIES

Panel plugs



Details

- Size: M8x1, M12x1
- Coding: A
- Number of poles: 3, 4, 5, 8
- With LED preparation
- Configuration: axial
- Housing configuration: plastic, metal, metal/plastic transparent
- Termination: solder-, print termination
- Degree of protection: IP67

Benefits

- Easy installation in housing by pushing in
- Low installation height
- Various connection possibilities

Power connectors



Details

- Size: M12x1, 7/8", Rund24
- Coding: L, S, T
- Number of poles: 3, 4, 2+PE, 3+PE, 4+PE, 4+FE, 6+PE
- Configuration: axial or angled
- Degree of protection: IP67

Benefits

- Transmission of high currents on minimum space requirements
- Different codings
- Mating can be controlled with torque wrench
- Defined tightening torque
- Polarity reversal prevented with coded insulators

ADDITIONAL CONEC PRODUCT CATEGORIES

High Temperature/Food & Beverage connectors



Details

- Size: M8x1, M12x1
- Coding: A
- Number of poles: 3, 4, 5
- Female connector, male connector
- Optional with LED
- Temperature-resistant up to 125 °C (HT)
- Degree of protection: IP65 (HT), IP67, IP69K (F&B)

Benefits

- Resistance to commercial aggressive cleaning agents
- Robust design with minimum space requirements
- Mating can be controlled with torque wrench
- Vibration proof screw lock
- Use in constantly high ambient temperatures

Connectors for BUS-Systems



Details

- Size: M8x1, M12x1, 7/8", RJ45
- Coding: A, B, D, P, X
- Number of poles: 4, 5, 8
- Profibus DP
- DeviceNet
- Industrial Ethernet 100 MHz
- EtherCAT P
- 10 Gigabit Ethernet
- Configuration: axial or angled

Benefits

- Robust design with minimum space requirements
- Vibration proof screw lock
- Application-related coloring of cables and contact insulators

ADDITIONAL CONEC PRODUCT CATEGORIES

Junction systems



Details

- Size: M8x1, M12x1, 7/8"
- Number of poles: 3, 4, 5, 8, 4+PE
- 1:1 wiring
- Signal distribution
- Degree of protection: IP67
- Assembly: retaining clip, protection caps

Benefits

- Robust design with minimum space requirements
- Signals and power are transmitted by standardized plug systems
- Back-to-back assembly with retaining clip
- Protection of unused interfaces

IP67 Power Bayonet



Details

- No. of poles: 2, 2+PE
- Receptacle male and female
- Cable connector male and female
- Degree of protection: IP67

Benefits

- Use in harsh environments
- Easy and secure locking by bayonet lock
- Cable to cable connection available
- High current carrying capability

ADDITIONAL CONEC PRODUCT CATEGORIES

IP67 Mini USB, USB 2.0, USB 3.0 connectors



Details

- Type: USB 3.0 Type A
- Type: USB 2.0 Type A, Mini USB Type A
- Housing: plastic, plastic metallized, zinc die-cast
- Locking: bayonet, M28
- Termination: soldering, PCB
- Adapters
- Degree of protection: IP20 (patch cord), IP67

Benefits

- Use in harsh environments
- Easy and secure locking by bayonet lock
- Front- and back panel mounting
- UV resistant material
- USB Memory Stick 2 GB integrated into protection cap
- Light-weight versions ideal for portable devices

IP67 RJ45 Industrial Ethernet connectors

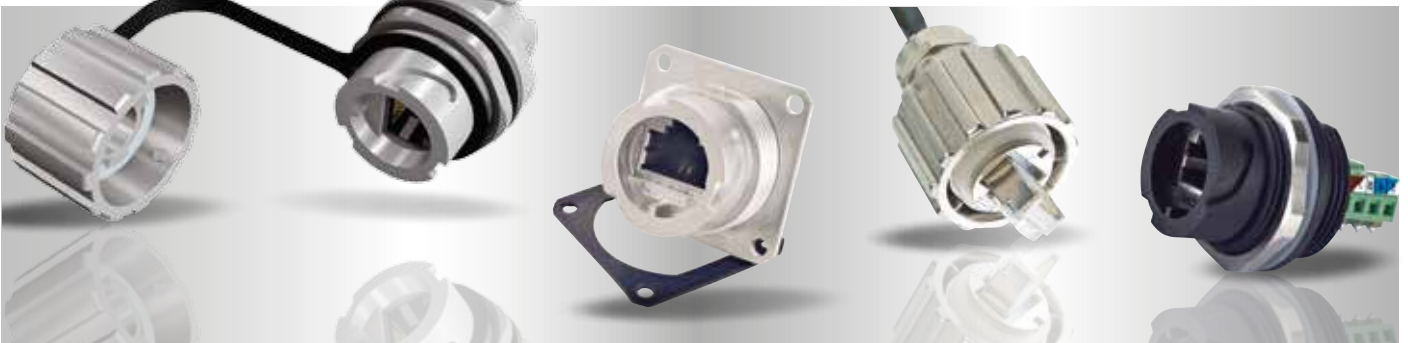

Details

- Housing: plastic, plastic metallized, zinc die-cast
- Locking: bayonet, M28
- Termination: soldering, IDC, screw
- UTP Cat 5e, STP Cat 5e, S/STP Cat 6A
- Degree of protection: IP20 (patch cord) IP67

Benefits

- Use in harsh environments
- Easy and secure locking by bayonet lock
- Front- and back panel mounting
- UV resistant material for outdoor use
- Light-weight versions
- Colored interface encoding available

ADDITIONAL CONEC PRODUCT CATEGORIES

IP67 Fiber Optic LC Duplex



Details

- Housing: plastic, plastic metallized, zinc die-cast
- Locking: bayonet
- Single Mode, Multi Mode, APC Single Mode
- Front- and back panel mounting
- Degree of protection: IP67

Benefits

- Use in harsh environments
- Easy and secure locking by bayonet lock
- Extended temperature range
- Interference-free safe data transmission
- Cost efficiency by integrated IP67 protection

D-SUB Steckverbinder Standard/High Density/Combination



Details

- Shell: steel tin plated, brass tin plated, stainless steel
- Termination: solder pin straight/angled, press-fit straight, solder cup, wire wrap, crimp
- Quality class: up to quality class 1

Benefits

- One interface for power, RF and control signals
- Space saving
- Cost saving – all in one connectors
- Low magnetic versions
- Customer-specific solutions possible
- Quick and easy locking and unlocking (SnapLock)

ADDITIONAL CONEC PRODUCT CATEGORIES

D-SUB filter standard/high density/combo



Details

- Shell: steel tin plated, brass tin plated
- Termination: solder pin, solder cup
- Filter type: C-Filter, LC-Filter, Pi-Filter
- High DWV

Benefits

- Filtering directly at interface
- Can be used without PCB Redesign
- Filter-adapter for retrofitting existing systems
- Up to 3-step low-pass filters
- Selective filtering
- Mixed capacitance
- Low magnetic versions
- Space saving on PCB

D-SUB hoods



Details

- Shell size: 1-5
- Shell: plastic, plastic metallized, metal
- Cable entry: straight, lateral, multiple
- CONEC SnapLock version

Benefits

- Large space for combination D-SUB
- Screw latching or slide locking
- Quick and easy locking (CONEC SnapLock)
- Touch protection of termination side
- For round and flat ribbon cables

ADDITIONAL CONEC PRODUCT CATEGORIES

IP67 D-SUB connectors standard/ high density/combo

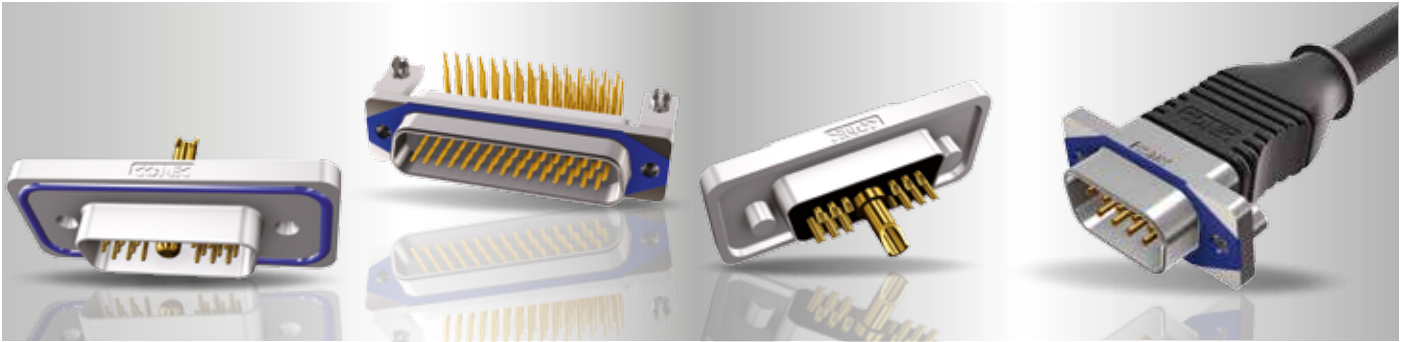

Details

- Shell: brass tin plated, stainless steel
- One-piece shell (Solid Body): zinc die-cast
- One-piece shell (CONEC SlimCon): zinc die-cast, small installation space requirements
- Termination: solder pin straight/angled, solder cup
- Degree of protection: IP67

Benefits

- Use in harsh environments
- Front- and back panel mounting
- Increased corrosion protection
- Precision machined contacts

IP67 D-SUB filter standard/high density



Details

- Shell: brass tin plated
- Termination: solder pin, solder cup
- Filter type: C-Filter up to 1300 pF (D-SUB) up to 1000 pF (HD-SUB)
- Degree of protection: IP67

Benefits

- Filtering directly at interface
- Can be used without PCB redesign
- Use in harsh environments
- Selective filtering
- Mixed capacitance
- Low magnetic versions
- Space saving on PCB

ADDITIONAL CONEC PRODUCT CATEGORIES

IP67 D-SUB hoods



Details

- Shell size: 1-5
- Shell: plastic, plastic metallized
- Degree of protection: IP67

Benefits

- Compact design
- Integrated cable gland
- Large space for combination D-SUB
- With shield connection
- UV resistant material for use outdoors
- Assembly without special tools

PCB connectors

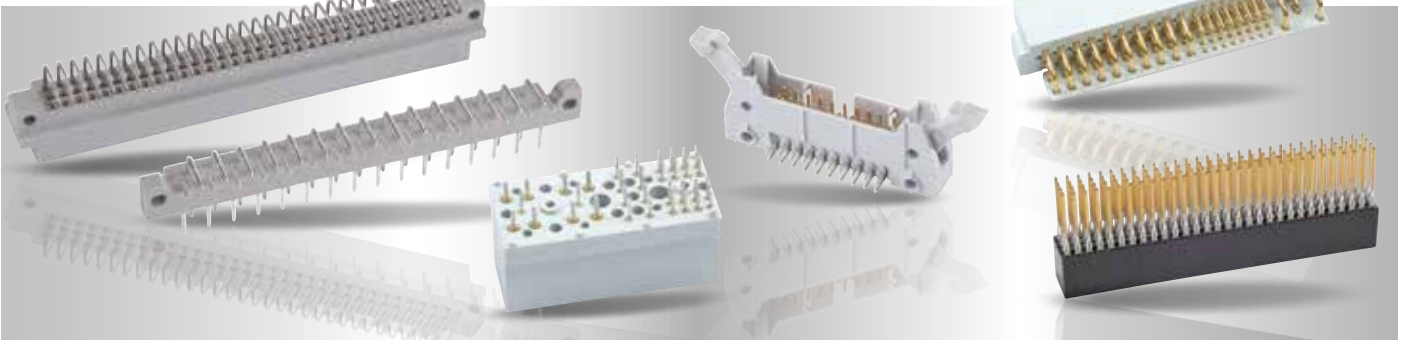

Overview

- DIN EN 60603-2 (DIN 41612)
- DIN 41617
- AdvancedTCA
- Flat cable connector
- CompactPCI
- PC104/PC104Plus

CONEC®

Despite a comprehensive product portfolio of industrial connectors, customer requirements cannot always be satisfied from standard products. In such cases, it is essential to develop custom specific solutions for mechanical and plant engineering as quickly as possible.



Are you looking for application-specific solutions?

The experienced CONEC design team creates solutions for you, for example:

- Special interconnect solutions to customer specifications
- Prototypes and small series production batches
- Connectors with increased IP ratings for harsh environments
- Enclosure technology for industrial use



CONEC

Elektronische Bauelemente GmbH
Ostenfeldmark 16
59557 Lippstadt
Germany

Tel. +49 2941 765-0
Fax +49 2941 76565
E-Mail info@conec.de
www.conec.com



CONEC Corporation
125 Sun Pac Blvd.
Brampton Ontario
Canada L6S 5Z6
Tel. +1 905 790 2200
Fax +1 905 790 2201
E-Mail info@conec.com



CONEC
343 Technology Drive
Garner, NC, USA 27529
Tel. +1 919 460 8800
Fax +1 919 460 0141
E-Mail info@conec.com



CONEC (UK) Limited
Suite 23
Thatcham House
Turner's Drive
Thatcham
Berkshire RG19 4QD
Tel. +44 1635 36929
E-Mail info@conec.co.uk



CONEC Polska Sp. zo.o
ul.Szmaragdowa 10
52-215 Wroclaw
Tel. +48 71 374 40 45
Fax +48 71 374 40 49
E-Mail info@conec.pl



CONEC s.r.o.
Loucka137
76325 Ujezd
Czech Republic
Tel. +420 577 350 132
Fax +420 577 350 134
E-Mail info@conec.cz



CONEC France SARL
202 Rue des Chevreuils
30320 Poulx
Tel. +33 9 75267217
Fax +33 4 66570916
E-Mail info@conec.fr



CONEC (Shanghai)
Int. Trading Co., Ltd.
Rm. 718 Yongding Bldg.
No. 3388 Gong He Xin Rd.
200436 Shanghai
Tel. +86 21 66300930
Fax +86 21 66300911
E-Mail info@conec.cn